

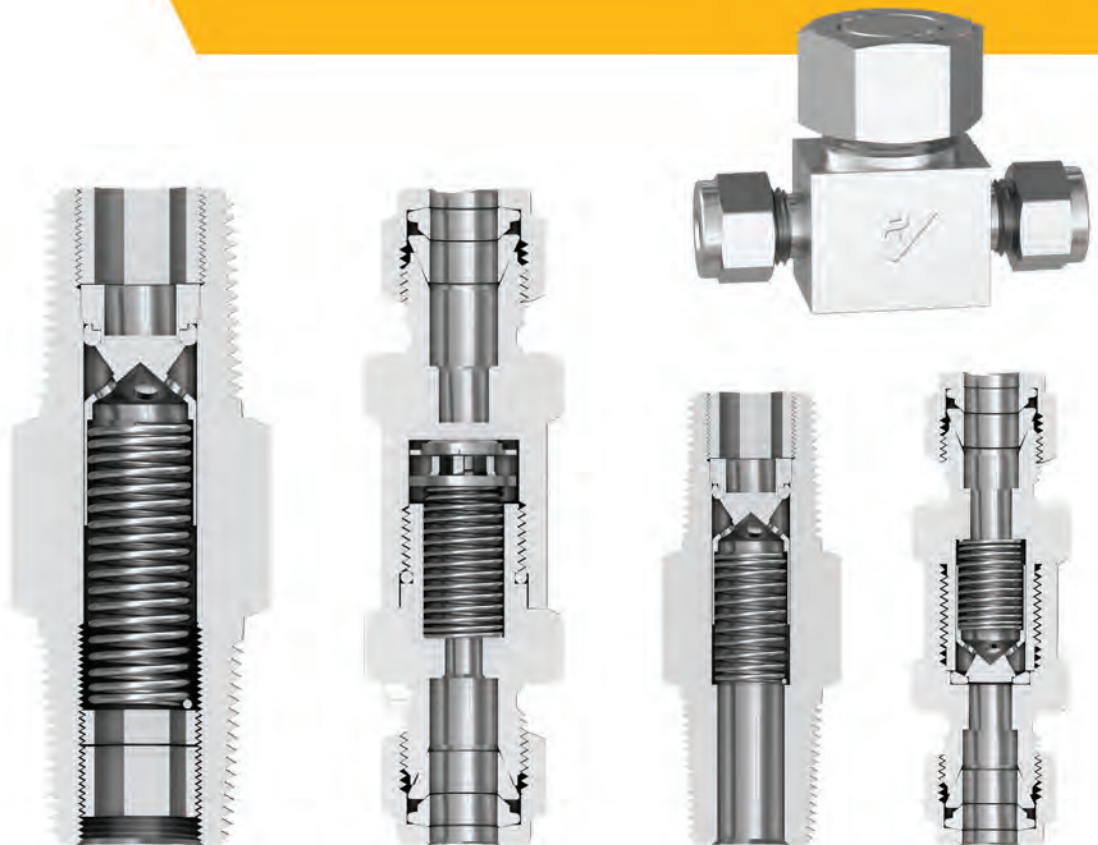

XYF-CKV 系列 单向阀

XYF - CKV Non-return Valve

SINYA



目录

CONTENT



- 10 ● -CKVA1型单向阀
Non-return Valve



- 11 ● -CKVA2型单向阀
Non-return Valve



- 12 ● -CKVA3型单向阀
Non-return Valve



- 13 ● -CKVB1型单向阀
Non-return Valve



- 13 ● -CKVB2型单向阀
Non-return Valve



- 15 ● -TCKV型提升单向阀
Lifting Non-return valv

● 产品概述

CKV系列单向阀结构紧凑，适用于仪表板和仪表系统。在系统中能够执行精确的操作，CKV系列阀门为常闭式止回阀，当入口和出口之间压力差高于弹簧的设定压力时，该阀门内的弹簧加载后将塞头向后移动，形成一个通道，液体可以通过。

● 产品特点

- 结构紧凑，体积小，外形美观
- 零件为通用件，具有互换性
- 可调节的固定启流压力弹簧
- 压力最高可达6000PSI (413bar)
- 结构材料316不锈钢或黄铜可选
- 多种端接形式和连接方式自选

● Product Description

With the compact structure, CKV series non-return valve is applicable for instrument panels and systems, which can be operated accurately. CKV series valves are usually used as check valves of normally closed type. When the drop pressure between the inlet and the outlet is higher than the set value of the spring, the spring inside the valve would move the plug afterwards to form a channel for passing through.

● Product Features

- Compact structure, small size & beautiful appearance
- The components are all of common type and can be interchangeable.
- Spring with fixed opening pressure can be adjusted.
- The pressure can be up to 6000 psi (413bar)
- Materials 316SS & brass can be selected.
- Multiple end connections for selection.

XYF-CKV系列单向阀

XYF — CKV Non-return Valve

● 固定开启压力 Fixed opening pressure

自from 1/3至To 25psi (0.03至1.8bar)

● CKV-A1型

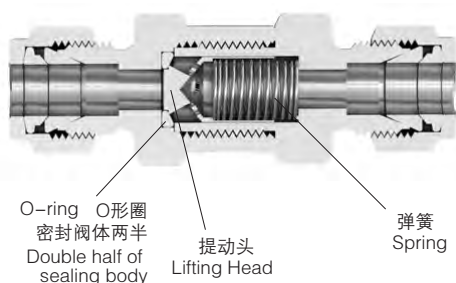

● 可调节开启压力 Adjustable opening pressure

自From 3至 to 600psi (0.21至41.4bar)

● CKV-B1型

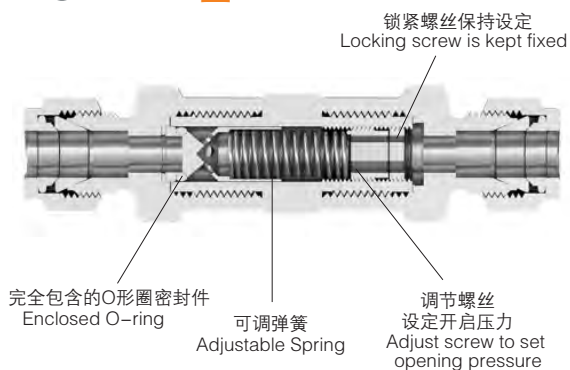

● CKV-A2型

Lifting Head with
sealing of caking elastomer

带有粘弹性体
密封件的提动头

提动头挡块
Chock block of lifting head

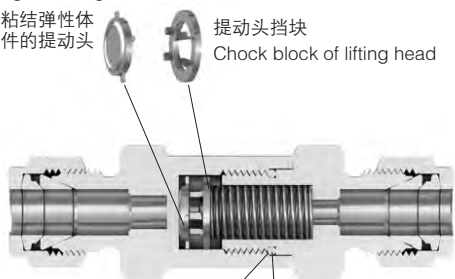

o形圈密封阀体两半
Double half of sealing body

支承环支撑o形圈
Supporting Ring to support O-ring

● CKV-B2型

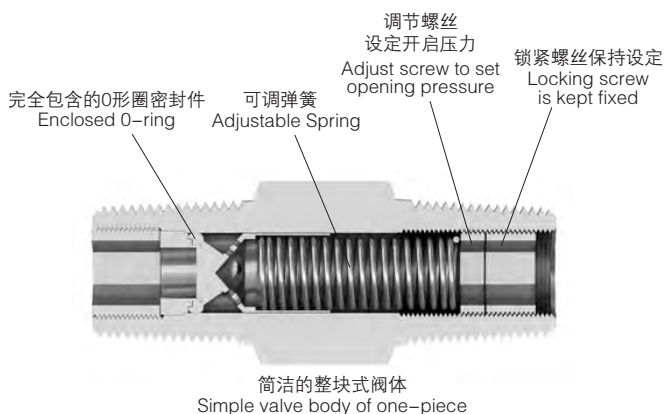

● CKV-A3型

完全包含的O形圈密封件
Enclosed O-ring

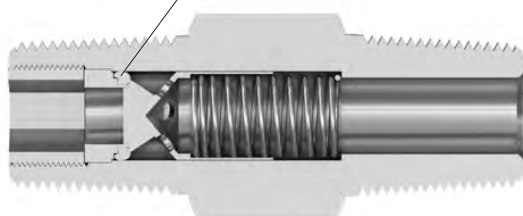

简洁的整块式阀体
Simple valve body of one-piece

● 技术数据 Technical Data

开启压力—最初指示流量发生的上游压力。

Opening Pressure—The upstream pressure generated from the starting indicated flow.

再封闭压力—无流量指示时的压力。

Re-closed pressure—Pressure without flow indication

型号规格 Specification	最大流量系数 (Cv) Max. Flow Coefficient	公称开启压力psi (bar) Nominal Opening Pressure	70 (20°C) 时的下游压力psig (bar) Downstream Pressure under 70 (20°C)	形式 Type
CKV-A1-2	0.10	1/3, 1, 10和25 (0.03, 0.07, 0.69和1.8)	1000 (68.9) ①	固定式 Fixed type
CKV-A1-4	0.47			
CKV-A1-6	1.47		200 (13.7)	
CKV-A1-8	1.68			
CKV-A1-12,16	4.48			
CKV-A2-4	0.67	1/3, 1, 5, 10和25 (0.03, 0.07, 0.35, 0.69和1.8)	6000 (413)	
CKV-A2-8	1.8		5000 (344)	
CKV-A2-16	4.7			
CKV-A3-4	0.35	1/3, 1, 10和25 (0.03, 0.07, 0.69和1.8)	3000 (206)	
CKV-A3-8	1.20			
CKV-B1	0.37	3至50 (0.21至3.5) 50至150 (3.5至10.4) 150至350 (10.4至24.2) 350至600 (24.2至41.4)	3000 (206)	可调式 Adjustable Type
CKV-B2-4	0.35			
CKV-B2-8	1.20			

① 对于25psi (1.8bar) 的开启压力, 下游压力为3000psig (206bar)。

For the opening pressure of 25 psi (1.8bar), the downstream pressure would be 3000psig (206bar).

● 压力—温度等级 Pressure— Temperature Class

CKV-A1、A3、B1、B2

在316不锈钢阀中, 额定值基于碳氟化合物FKM O形圈, 在黄铜阀中, 额定值基于丁腈橡胶O形圈。

For valves made of 316ss, the rated value is based on FKM O-ring. For valves made of brass, the rated value is based on NBR O-ring

材料 Material 温度, Temperature °F (°C)	316SS	黄铜 Brass
	工作压力 Working Temperature, psig (bar)	
-10 (-23) 至100 (37)	3000 (206)	13000 (206)
200 (93)	2575 (177)	2600 (179)
250 (121)	2450 (168)	2405 (165)
300 (148)	2325 (160)	—
375 (190)	2185 (150)	—

● 技术数据 Technical Data

开启压力—最初指示流量发生的上游压力。

Opening Pressure—The upstream pressure generated from the starting indicated flow.

再封闭压力—无流量指示时的压力。

Re-closed pressure—Pressure without flow indication

型号规格 Specification	最大流量系数 (Cv) Max. Flow Coefficient	公称开启压力psi (bar) Nominal Opening Pressure	70 (20°C) 时的下游压力psig (bar) Downstream Pressure under 70 (20°C)	形式 Type
CKV-A1-2	0.10	1/3, 1, 10和25 (0.03, 0.07, 0.69和1.8)	1000 (68.9) ①	固定式 Fixed type
CKV-A1-4	0.47			
CKV-A1-6	1.47		200 (13.7)	
CKV-A1-8	1.68			
CKV-A1-12,16	4.48			
CKV-A2-4	0.67	1/3, 1, 5, 10和25 (0.03, 0.07, 0.35, 0.69和1.8)	6000 (413)	
CKV-A2-8	1.8		5000 (344)	
CKV-A2-16	4.7			
CKV-A3-4	0.35	1/3, 1, 10和25 (0.03, 0.07, 0.69和1.8)	3000 (206)	
CKV-A3-8	1.20			
CKV-B1	0.37	3至50 (0.21至3.5) 50至150 (3.5至10.4) 150至350 (10.4至24.2) 350至600 (24.2至41.4)	3000 (206)	可调式 Adjustable Type
CKV-B2-4	0.35			
CKV-B2-8	1.20			

① 对于25psi (1.8bar) 的开启压力, 下游压力为3000psig (206bar)。

For the opening pressure of 25 psi (1.8bar), the downstream pressure would be 3000psig (206bar).

● 压力—温度等级 Pressure— Temperature Class

CKV-A1、A3、B1、B2

在316不锈钢阀中, 额定值基于碳氟化合物FKM O形圈, 在黄铜阀中, 额定值基于丁腈橡胶O形圈。

For valves made of 316ss, the rated value is based on FKM O-ring. For valves made of brass, the rated value is based on NBR O-ring

材料 Material 温度, Temperature °F (°C)	316SS	黄铜 Brass
	工作压力 Working Temperature, psig (bar)	
-10 (-23) 至100 (37)	3000 (206)	13000 (206)
200 (93)	2575 (177)	2600 (179)
250 (121)	2450 (168)	2405 (165)
300 (148)	2325 (160)	—
375 (190)	2185 (150)	—

XYF — CKV Non-return Valve

● CKV-A1 (12、16)

在316不锈钢阀中，额定值基于碳氟化合物FKM O形圈，

在黄铜阀中，额定值基于丁腈橡胶O形圈。

For valves made of 316ss, the rated value is based on FKM O-ring. For valves made of brass, the rated value is based on NBR O-ring.

材料 Material	316SS	黄铜Brass
温度 Temperature °F (°C)	工作压力 Working Temperature, psig (bar)	
-10 (-23) 至100 (37)	3000 (206)	13000 (206)
200 (93)	2575 (177)	2600 (179)
250 (121)	2450 (168)	2405 (165)
300 (148)	2325 (160)	—
375 (190)	2185 (150)	—

● CKV-A2

额定值基于碳氟化合物FKM 密封件。

Rated value is based on FKM sealing.

材料 Material	316SS	
型号 Model	A2-4, A2-8	A2-16
温度 Temperature °F (°C)	工作压力 Working Temperature, psig (bar)	
-10 (-23) 至100 (37)	6000 (413)	5000(344)
200 (93)	5160 (355)	4290(295)
250 (121)	4910 (338)	4080(281)
300 (148)	4660 (321)	3875(266)
400 (204)	4280 (294)	3560(245)

对于一段时间未启动过的阀，初始开启压力可能大于设定的开启压力。

The starting opening pressure might be higher than the set opening pressure for those valves unused for a long time.

● 70(20°C)时的开启压力和再封闭压力

Opening pressure & Re-closed Pressure at the temperature of 70 (20°C)

开启压力-最初指示流量发生的上游压力。

Opening Pressure-Indicate the upstream pressure resulted from the flow at the beginning.

再封闭压力-无流量指示时的压力。

Re-closed pressure-Pressure without flow indication.

扬中新亚自控工程有限公司

YANGZHONG SINYA AUTO-CONTROL ENGINEERING CO.,LTD.

CKV-A1

公称开启压力 Nominal Opening Pressure psi (bar)	开启压力范围 Pressure Range psi (bar)	再封闭压力 Re-closed pressure psi (bar)
-1/3 (0.03)	3 (0.21) 以下 Less than 3(0.21)	16 (0.42) 以下 下游压力 Downstream Pressure is less than 6(0.42)
1 (0.07)	4 (0.28) 以下	6 (0.42) 以下 下游压力 Downstream Pressure is less than 6(0.42)
10 (0.69)	7至15 (0.49至1.1) 7 to 15(0.49 to 1.1)	3 (0.21) 或以上 上游压力 Upstream pressure is more than 3(0.21)
25 (1.8)	20至30 (1.4至2.1) 20 to 30 (1.4 to 2.1)	17 (1.2) 或以上 上游压力 Upstream pressure is more than 3(0.21)

CKV-A2

公称开启压力 Nominal Opening Pressure psi (bar)	开启压力范围 Pressure Range psi (bar)	再封闭压力 Re-closed pressure psi (bar)
1/3 (0.03)	Up to 3 (0.21)	6 (0.42) 以下背压 The negative pressure is below than 6 (0.42)
1 (0.07)	Upto 4 (0.28)	5 (0.35) 以下背压 The negative pressure is below than 5 (0.35)
5 (0.35)	3 to 9 (0.21 to 0.63)	2 (0.14) 以下背压 The negative pressure is below than 2 (0.14)
10 (0.69)	7 to 15 (0.49 to 1.1)	3 (0.21) 或以上 上游压力 Upstream pressure is more than 3 (0.21)
25 (1.8)	20 to 30 (1.4 to 2.1)	17 (1.2) 或以上 上游压力 Upstream pressure is more than 17(0.21) (1.2)

CKV-A3

公称开启压力 Nominal Opening Pressure psi (bar)	开启压力范围 Pressure Range psi (bar)	再封闭压力 Re-closed pressure psi (bar)
-1/3 (0.03)	3 (0.21) 以下 Less than 3 (0.21)	6至20 (0.42至1.4) 下游压力 Downstream pressure is from 6 to 20 (0.42 to 1.4)
1 (0.07)	4 (0.28) 以下 Less than 4 (0.28)	5至20 (0.35至1.4) 下游压力 Downstream pressure is from 5 to 20 (0.35 to 1.4)
10 (0.69)	7 to 13 (0.49 to 0.90)	3至10 (0.21至0.69) 下游压力 Downstream pressure is from 3 to 10 (0.21 to 0.69)
25 (1.8)	20 to 29 (1.5 to 2.0)	5 (0.35) 或以上 上游压力 Upstream pressure is from 5 (0.35).

CKV-B1.B2

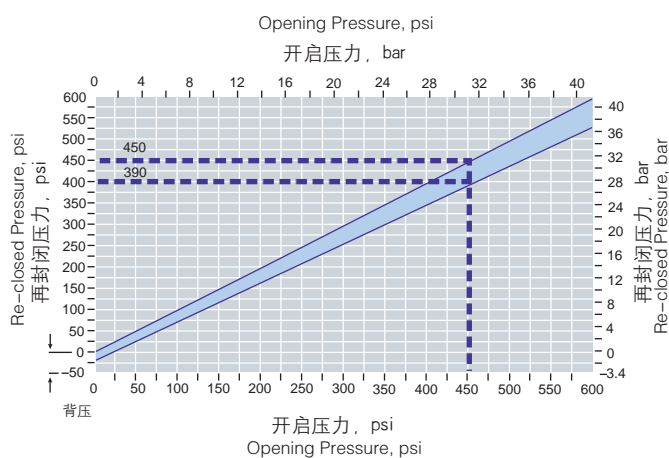

对于一段时间未启动过的阀，初始开启压力可能大于设定的开启压力。

For those valves not used for a long time, the starting opening pressure would might be more than the opening pressure set.

XYF-CKV系列单向阀

XYF — CKV Non-return Valve

● 结构材料 Structure Material

CKV-A1型

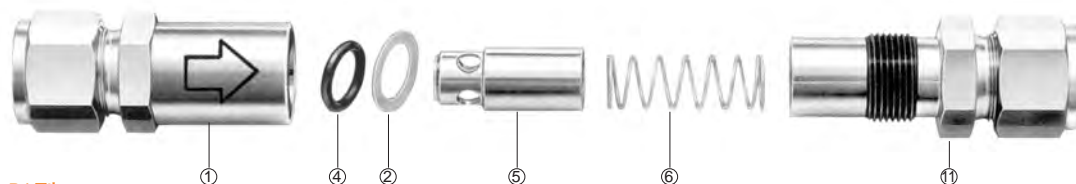

CKV-B1型

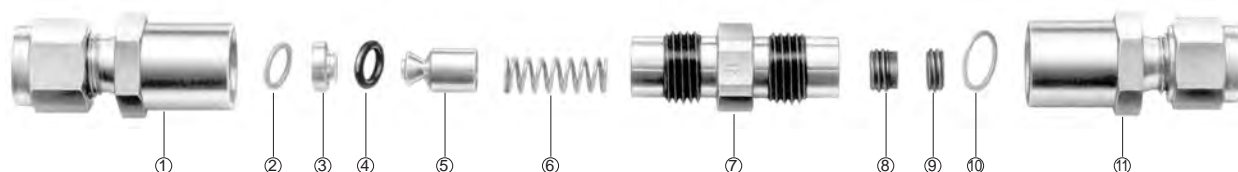

● CKV-A1、CKV-B1型

件号 Part No.	元件名称 Component Name	阀体材料 Body Material		适用型号 Applicable Model
		316SS 材料等级/ASTM规格 Material Grade/ASTM specifications	316SS 316SS/A240 LF2/B209	
1	入口阀体 Inlet Body	316SS/A479	黄铜Brass/360/B16	
2	入口垫圈 Inlet Washer	316SS/A240	316SS/A240 LF2/B209	
3	插入件 Insert	316SS/A479	黄铜Brass485/B21	CKV-A1
4	O形圈 O-ring	碳氟FKM	丁腈橡胶NBR	CKV-B1
5	提动头 Lifting Head	316SS/A479	黄铜Brass/360/B16	
6	弹簧 Spring	302SS/A313		
7	中间体 Midbody	316SS/A479	黄铜Brass/360/B16	
8	调节螺丝 Adjusting Screw	316SS/A276	316SS/A276	
9	锁定螺丝 Locking Screw	316SS/A276	316SS/A276	CKV-B1
10	出口垫圈 Outlet Washer	316SS/A240	316SS/A240	
11	出口阀体Outlet Body	316SS/A479	黄铜Brass/360/B16	

● CKV-A2型

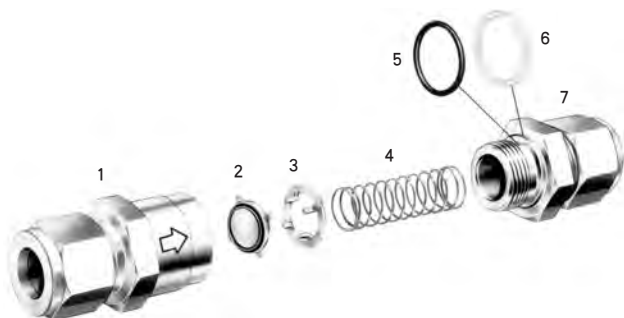

件号 Part No.	元件名称 Component Name	材料等级/ASTM规格 Material Grade/ASTM specifications
1	入口阀体 Inlet Body	316SS/A479
2	提动头 Lifting Head	碳氟FKM/316SS
3	挡块 Chock block	316SS/A240
4	弹簧 Spring	302SS/313
5	O形圈 O-ring	碳氟FKM
6	支承环 Supporting Ring	PTFE/D1710
7	出口阀体 Outlet Body	316SS/A479

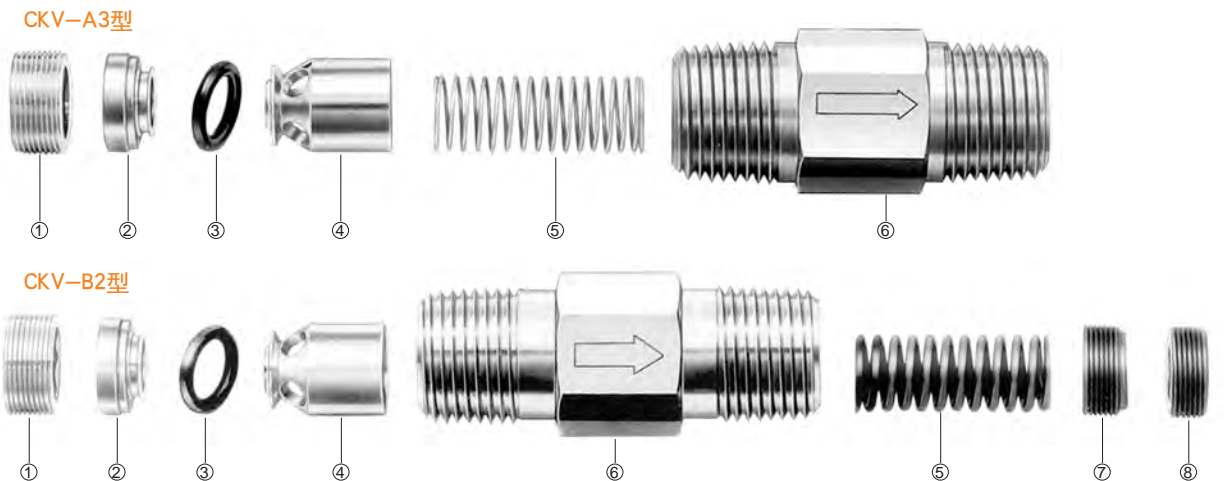

CKV-A3、B2型

件号 Part No.	元件名称 Component Name	316SS	阀体材料 Body Material				适用型号 Applicable Model
			CKV-A3型		CKV-B2型		
			材料等级/ASTM规格Material Grade/ASTM specifications				
1	插入锁定螺丝 Locking Screw Inserting	316SS/A276、A479	黄铜 Brass485/B21	黄铜 Brass360/B16	黄铜 Brass360/B16	黄铜 Brass360/B16	CKV-A3
2	插入件 Inserter	316SS/A479	黄铜 Brass485/B21	黄铜 Brass360/B16	黄铜 Brass360/B16	黄铜 Brass360/B16	
3	O形圈 O-ring	碳氟FKM	丁腈橡胶NBR				
4	提动头 Lifting Head	316SS/A479	黄铜Brass316/B16				
5	弹簧 Spring	302SS/A313	302SS/A313				
6	阀体 Valve Body	316SS/A479	黄铜Brass316/B16				
7	调节螺丝 Adjustable Screw	316SS/A276	黄铜 Brass485/B21	黄铜 Brass360/B16	黄铜 Brass360/B16	黄铜 Brass360/B16	CKV-B2
8	锁定螺丝 Locking Screw	316SS/A276	黄铜 Brass485/B21	黄铜 Brass360/B16	黄铜 Brass360/B16	黄铜 Brass360/B16	CKV-B2

密封材料 (所有系列) Sealing Material (for all models)

316不锈钢阀中, 碳氟FKM O形圈是标准配置。黄铜阀中丁腈橡胶O形圈是标准配置, 可供其他弹性体密封件(提动头粘材料)和O形圈)。

需订购时在阀门基本订货号中插入密封材料代号。

FKM o-ring is the standard component for 316SS valves. NBR o-ring is the standard component for brass valves. Also some other kinds of sealing materials with elastomer (caking materials for lifting head and o-ring) can be selected. Please make special description while ordering if special sealing material is needed.

密封材料 Sealing Materials	代号 Code	温度等级 Temperature Class
丁腈材料 NBR	-BU	-10~250 (-23~121)
乙烯丙烯 PP/PE	-EP	-50~300 (-45~148)
碳氟FKM	-V1	-10~375 (-23~190)
氯丁合成橡胶 Neoprene	-NE	-40~250 (-40~121)

特种合金 (所有系列)

Special Alloy (for all models)

许多阀体可由其它合金材料制成, 订购时在基本订货号前添加特种合金代号。

Valve body can also be made of some other special alloy. Please add the code of the special alloy to the basic order information while ordering.

XYF-CKV系列单向阀



XYF — CKV Non-return Valve

● 订购信息及选型 Order information & Selection



A材料 Material		
B	=	黄铜 Brass
SS	=	316不锈钢 SS

B系列号=CKV

C结构		
A1	=	固定开启压力 Fixed Opening Pressure
A2	=	固定开启压力 Fixed Opening Pressure
A3	=	固定开启压力 Fixed Opening Pressure
B1	=	可调开启压力 Adjustable Opening Pressure
B2	=	可调开启压力 Adjustable Opening Pressure

D端接		
SK	=	双卡套 Double Ferrule
LWF	=	内螺纹 Female Thread
LWM	=	外螺纹 Male Thread
MES	=	外螺纹端口密封 Male End sealing

E端接尺寸				
英制 (in)		公制 (mm)		
1/8	=	2	3	= 3mm
1/4	=	4	6	= 6mm
3/8	=	6	8	= 8mm
1/2	=	8	10	= 10mm
3/4	=	12	12	= 12mm
1	=	16	18	= 18mm
			22	= 22mm
			25	= 25mm

F开启压力 Opening Pressure		
psi	(bar)	代号 Code
1/3	0.03	1/3
1	0.07	1
5	0.35	5
10	0.69	10
25	1.80	25
3~50	0.21~3.5	3
50~150	3.5~10.4	50
150~350	10.4~24.2	150
350~600	24.2~41.4	350

● **订货号样例** 代表具有以下特点CKV系列单向阀
 Example For ordering code represents CKV non-return valve with the following features

B-CKVA2-SK-6-1		
B	=	黄铜 Brass
CKV	=	系列代号 serial code
A2	=	固定开启压力 Fixed opening pressure
SK	=	双卡套端接 double-ferrule connection
6	=	端接尺寸3/8in end size
1	=	开启压力代号 code for opening pressure

SS-CKVB2-LWM-8-10		
SS	=	316不锈钢 SS
CKV	=	系列代号 serial code
B2	=	可调开启压力 Adjustable opening pressure
LWM	=	外螺纹端接 Male connection
8	=	端接尺寸1/2in end size
10	=	开启压力代号 code for opening pressure

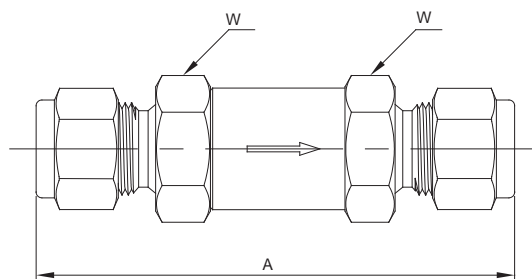
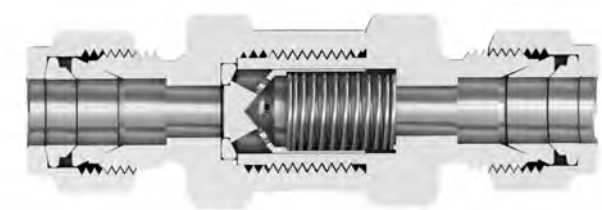

● -CKVA1型单向阀 Non-return Valve

基本订货号 Order information	端接尺寸 End Connection Size		A		W	
	英寸 (in)	毫米 (mm)	英寸 (in)	毫米 (mm)	英寸 (in)	毫米 (mm)
-CKVA1-SK-2	1/8	3.17	2.20	56.0	0.63	15.88
-CKVA1-SK-4	1/4	6.35	2.38	60.5	0.63	15.88
-CKVA1-SK-6	3/8	9.52	2.48	63.0	0.69	17.4
-CKVA1-SK-8	1/2	12.70	3.03	77.0	0.94	23.8
-CKVA1-SK-12	3/4	19.05	3.48	88.5	1.13	28.6
-CKVA1-SK-16	1	25.40	4.72	120.0	1.37	34.9
-CKVA1-SK-6mm	0.24	6	2.38	60.5	0.63	15.88
-CKVA1-SK-10mm	0.39	10	2.50	63.5	0.69	17.4
-CKVA1-SK-12mm	0.47	12	3.03	77.0	0.94	23.8
-CKVA1-LWF-2	NPT1/8		1.89	48.0	0.63	15.88
-CKVA1-LWF-4	NPT1/4		2.15	54.6	0.75	19.05
-CKVA1-LWF-6	NPT3/8		2.98	75.7	0.87	22.2
-CKVA1-LWF-8	NPT1/2		3.58	91.0	1.06	27.0
-CKVA1-LWF-12	NPT3/4		4.09	104.0	1.26	32.0
-CKVA1-LWF-16	NPT1		4.84	123.0	1.62	41.2
-CKVA1-LWM-2	NPT1/8		1.71	43.4	0.63	15.88
-CKVA1-LWM-4	NPT1/4		2.09	53.1	0.63	15.88
-CKVA1-LWM-6	NPT3/8		2.78	70.6	0.87	22.2
-CKVA1-LWM-8	NPT1/2		3.16	80.3	0.87	22.2
-CKVA1-LWM-12	NPT3/4		4.09	104.0	1.26	32.0
-CKVA1-LWM-16	NPT1		4.53	115.0	1.62	41.2

● 订购数据 Order Data

在基本订货号前加材料代号。

Add material code in front of the basic order number.

B为黄铜, SS为316不锈钢

B indicates brass and ss indicates 316 stainless steel.

● -CKVA1型

要订购时, 在基本订货号后面添加开启压力代号。

Add the opening press code in front of the basic order number.

开启压力 Opening Pressure psi (bar)	代号 Code
1/3 (0.03)	1/3
1 (0.07)	1
10 (0.69)	10
25 (1.80)	25

XYF-CKV系列单向阀



XYF — CKV Non-return Valve

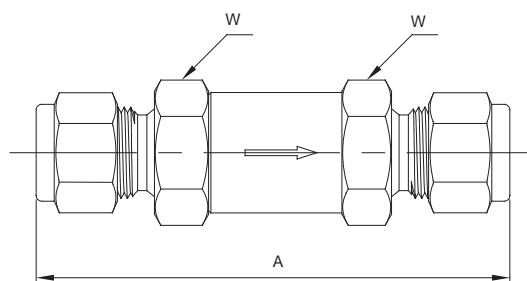

CKVA2型单向阀 Non-return Valve

基本订货号 Order information	端接尺寸 End Connection Size		A		W		温度为100°F(37°C)时的压力 额定值psi(bar) The rated pressure psi(bar) under the temperature of 100 °F (37°C)
	英寸 (in)	毫米 (mm)	英寸 (in)	毫米 (mm)	英寸 (in)	毫米 (mm)	
-CKVA2-SK-2	1/8	3.17	2.28	58.0	0.69	17.4	6000(413)
-CKVA2-SK-4	1/4	6.35	2.44	62.0	0.69	17.4	6000(413)
-CKVA2-SK-6	3/8	9.52	2.76	70.0	1.00	25.4	6000(413)
-CKVA2-SK-8	1/2	12.70	2.95	75.0	1.00	25.4	6000(413)
-CKVA2-SK-12	3/4	19.05	3.52	89.5	1.62	41.2	5000(344)
-CKVA2-SK-16	1	25.40	3.82	97.0	1.62	41.2	4700(323)
-CKVA2-SK-6mm	0.24	6	2.44	62.0	0.69	17.4	6000(413)
-CKVA2-SK-8mm	0.31	8	2.72	69.0	1.00	25.4	6000(413)
-CKVA2-SK-10mm	0.39	10	2.80	71.0	1.00	25.4	6000(413)
-CKVA2-SK-12mm	0.47	12	2.95	75.0	1.00	25.4	6000(413)
-CKVA2-SK-22mm	0.87	22	3.48	88.5	1.62	41.2	5000(344)
-CKVA2-SK-25mm	0.98	25	3.88	98.5	1.62	41.2	5000(344)
-CKVA2-LWF-4	NPT1/4		2.13	54.0	0.69	17.4	6000(413)
-CKVA2-LWF-6	NPT3/8		2.56	65.0	1.00	25.4	5000(344)
-CKVA2-LWF-8	NPT1/2		3.03	77.0	1.06	27.0	4600(316)
-CKVA2-LWF-12	NPT3/4		3.23	82.0	1.62	41.2	4300(296)
-CKVA2-LWF-16	NPT1		3.82	97.0	1.62	41.2	4100(282)
-CKVA2-LWM-2	NPT1/8		1.79	45.5	0.69	17.4	6000(413)
-CKVA2-LWM-4	NPT1/4		2.19	55.5	0.69	17.4	6000(413)
-CKVA2-LWM-6	NPT3/8		2.36	60.0	1.00	25.4	6000(413)
-CKVA2-LWM-8	NPT1/2		2.72	69.0	1.00	25.4	6000(413)
-CKVA2-LWM-12	NPT3/4		3.29	83.5	1.62	41.2	5000(344)
-CKVA2-LWM-16	NPT1		3.66	93.0	1.62	41.2	5000(344)
-CKVA2-LWF-4R	BSPT1/4		2.28	58.0	0.69	17.4	6000(413)
-CKVA2-LWF-8R	BSPT1/2		3.29	83.5	1.06	27.0	4600(316)
-CKVA2-LWF-12R	BSPT3/4		3.54	90.0	1.62	41.2	4300(296)
-CKVA2-LWF-16R	BSPT1		3.82	97.0	1.62	41.2	4100(282)
-CKVA2-LWM-4R	BSPT1/4		2.17	55.0	0.69	17.4	6000(413)
-CKVA2-LWM-8R	BSPT1/2		2.72	69.0	1.00	25.4	4600(316)
-CKVA2-LWM-12R	BSPT3/4		3.35	85.0	1.62	41.2	4300(296)
-CKVA2-LWM-16R	BSPT1		3.66	93.0	1.62	41.2	4100(282)

订购数据 Order Data

CKVA2型

要订购时，在基本订货号后面添加开启压力代号。

Add the opening press code in front of the basic order number.

开启压力 Opening Pressure psi (bar)	代号 Code
1/3 (0.03)	1/3
1 (0.07)	1
5(0.35)	1
10 (0.69)	10
25 (1.80)	25

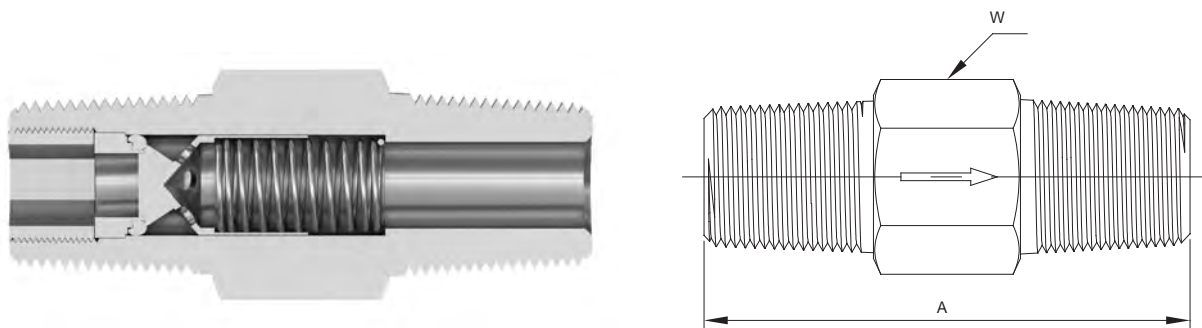

● -CKVA3型单向阀 Non-return Valve

基本订货号 Order information	端接尺寸 End Connection Size	A		W	
		英寸 (in)	毫米 (mm)	英寸 (in)	毫米 (mm)
-CKVA3-LWF-4	NPT1/4	2.44	62	0.75	19.05
-CKVA3-LWF-8	NPT1/2	3.74	95	1.06	27.0
-CKVA3-LWM-4	NPT1/4	1.61	41	0.56	14.2
-CKVA3-LWM-8	NPT1/2	2.28	58	0.87	22.2
-CKVA3-FM-4	NPT1/4	1.77	45	0.75	19.05
-CKVA3-FM-8	NPT1/2	2.83	72	1.06	27.0
-CKVA3-LWF-4R	BSPT1/4	2.56	65	0.75	19.05
-CKVA3-LWF-8R	BSPT1/2	3.62	92	1.06	27.0
-CKVA3-LWM-4R	BSPT1/4	1.61	41	0.56	14.2
-CKVA3-LWM-8R	BSPT1/2	2.28	58	0.87	22.2

● 订购数据 Order Data

在基本订货号前加材料代号。

Add material code in front of the basic order number.

B为黄铜，SS为316不锈钢

B indicates brass and ss indicates 316 stainless steel.

● -CKVA3型

要订购时，在基本订货号后面添加开启压力代号。

Add the opening press code in front of the basic order number.

开启压力 Opening Pressure psi (bar)	代号 Code
1/3 (0.03)	1/3
1 (0.07)	1
10 (0.69)	10
25 (1.80)	25

XYF-CKV系列单向阀



XYF — CKV Non-return Valve

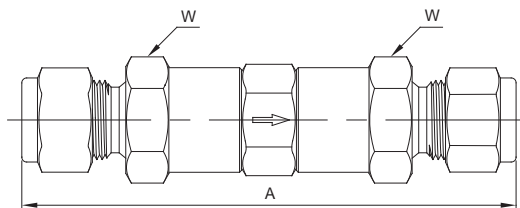

● -CKVB1型单向阀 Non-return Valve

基本订货号 Order information	端接尺寸 End Connection Size		A		W	
	英寸 (in)	毫米 (mm)	英寸 (in)	毫米 (mm)	英寸 (in)	毫米 (mm)
-CKVB1-SK-4	0.25	6.35	3.23	82	0.56	14.2
-CKVB1-SK-6mm	0.24	6	3.23	82	0.56	14.2
-CKVB1-SK-8mm	0.31	8	3.35	85	0.69	17.4
-CKVB1-SKM-4-4	0.25	6.35	3.15	80	0.56	14.2

● 订购数据 Order Data

在基本订货号前加材料代号。
Add material code in front of the basic order number.
B为黄铜，SS为316不锈钢
B indicates brass and ss indicates 316 stainless steel.

● -CKVB1型

要订购时，在基本订货号后面添加开启压力代号。
Add the opening press code in front of the basic order number.

开启压力 Opening Pressure psi (bar)	代号 Code
3~50(0.21~3.5)	3
50~150(3.5~10.4)	50
150~350(10.4~24.2)	150
350~600(24.2~41.4)	350

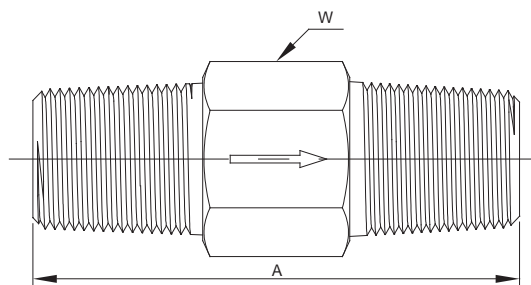

● -CKVB2型单向阀 Non-return Valve

基本订货号 Order information	端接尺寸 End Connection Size	A		W	
		英寸 (in)	毫米 (mm)	英寸 (in)	毫米 (mm)
-CKVB2-LWF-4	NPT1/4	2.99	76	0.75	19.05
-CKVB2-LWF-8	NPT1/2	3.86	98	1.06	27.0
-CKVB2-LWM-4	NPT1/4	1.65	42	0.56	14.2
-CKVB2-LWM-8	NPT1/2	2.28	58	0.87	22.2
-CKVB2-LWF-4R	BSPT1/4	2.99	76	0.75	19.05
-CKVB2-LWF-8R	BSPT1/2	3.86	98	1.06	27.0
-CKVB2-LWM-4R	BSPT1/4	1.65	42	0.56	14.2
-CKVB2-LWM-8R	BSPT1/2	2.28	58	0.87	22.2

● 订购数据 Order Data

● CKVB2型

要订购时，在基本订货号后面添加开启压力代号。
Add the opening press code in front of the basic order number.

开启压力 Opening Pressure psi (bar)	代号 Code
3~50(0.21~3.5)	3
50~150(3.5~10.4)	50
150~350(10.4~24.2)	150
350~600(24.2~41.4)	350

● TCKV系列提升单向阀 TCKV series Lifting Non-return Valve

扬中新亚提升单向阀在压力6000psig (413bar) 和温度900 (482℃) 以下能抑制反向流动。

正向流动能提升起提动阀芯，将阀打开。反向流动使提动阀芯落在孔口上，将阀关闭。

The lifting non-return valve supplied by Yangzhong Xinya can hold down the reversed flowing under the pressure of 6000psig with the temperature of 900 (482℃). The valve would be opened with the positive flowing by lifting the valve core and it would be closed with the reversed flowing by falling the valve core down on the hole.

提升单向阀是依靠重力来动作的，故必需水平地安装，阀帽螺母在上部。

The valve should be installed horizontally with the cap and nut on the top because the valve is functioned with the gravity.

● 特点 Features

- 结构坚固，全不锈钢结构 hard structure all made by stainless steel
- 反向流动系数0.1% 0.1% of the reversed flowing coefficient
- 无弹簧或弹性体 without spring or elastomer
- 尺寸紧凑 compact size

联合阀帽设计 United valve cap design

金属对金属密封 metal to metal sealing

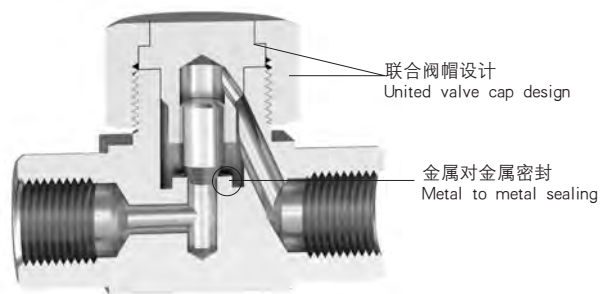

● 压力-温度等级 Pressure-temperature

ASME等级 Class	2500
材料组别 Material Group	2.2
材料名称 Material Name	316SS
温度 Temperature °F(°C)	工作压力psig (bar) Operating Pressure
-65 (-53) 至100 (37)	6000 (413)
200 (93)	5160 (355)
250 (121)	4910 (338)
300 (148)	4660 (321)
350 (176)	4470 (307)
400 (204)	4280 (294)
450 (232)	4130 (284)
500 (260)	3980 (274)
600 (315)	3760 (259)
650 (343)	3700 (254)
700 (371)	3600 (248)
750 (398)	3520 (242)
800 (426)	3460 (238)
850 (454)	3380 (232)
900 (482)	3280 (225)

● 结构材料 Structure Material

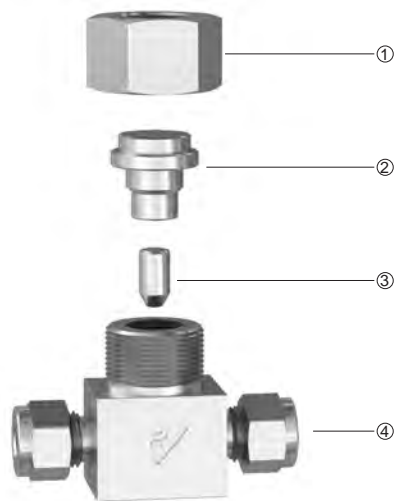

元件 Component	材料等级/ASTM规格 Material Class/ASTM specification
1 阀帽螺母 Cap nut	316SS/A476
2 阀帽 Cap	316SS/A476
3 提动阀芯 Lifting core	S17400/A564
4 阀体 valve body	316SS/A476

XYF-CKV系列单向阀



XYF — CKV Non-return Valve

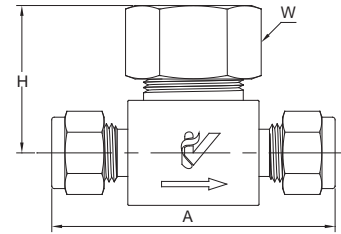
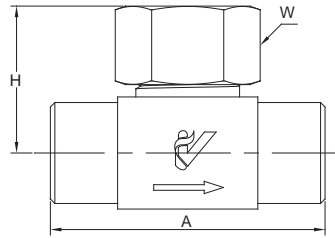

● -TCKV型提升单向阀 Lifting Non-return valve

基本订货号 Order information	端接尺寸		孔口尺寸		流量系数 Cv	A		H		W	
	英寸 (in)	毫米 (mm)	英寸 (in)	毫米 (mm)		英寸 (in)	毫米 (mm)	英寸 (in)	毫米 (mm)	英寸 (in)	毫米 (mm)
-TCKV-SK-4	1/4	6.35	0.16	4.0	0.30	2.40	61	1.08	27.5	A	22
-TCKV-SK-6	3/8	9.52	0.25	6.4	0.64	2.83	72	1.36	34.5	1.26	32
-TCKV-SK-8	1/2	12.70	0.44	11.1	2.20	3.90	99	1.83	46.5	1.50	38
-TCKV-SK-12	3/4	19.05	0.44	11.1	2.20	3.90	99	1.83	46.5	1.50	38
-TCKV-SK-6mm	0.24	6	0.16	4.0	0.30	2.40	61	1.08	27.5	0.87	22
-TCKV-SK-10mm	0.39	10	0.25	6.4	0.64	2.83	72	1.36	34.5	1.26	32
-TCKV-SK-12mm	0.47	12	0.44	11.1	2.20	3.90	99	1.83	46.5	1.50	38
-TCKV-SK-18mm	0.71	18	0.44	11.1	2.20	3.90	99	1.83	46.5	1.50	38
-TCKV-LWF-2	NPT1/8		0.16	4.0	0.30	2.01	51	1.08	27.5	0.87	22
-TCKV-LWF-4	NPT1/4		0.25	6.4	0.64	2.24	57	1.36	34.5	0.87	22
-TCKV-LWF-6	NPT3/8		0.44	11.1	2.20	3.11	79	1.83	46.5	1.50	38
-TCKV-LWF-8	NPT1/2		0.44	11.1	2.20	3.11	79	1.83	46.5	1.50	38
-TCKV-SKF-4-4	1/4/NPT1/4		0.16	4.0	0.30	2.24	57	1.08	27.5	0.87	22
-TCKV-SKF-6-6	3/8/NPT3/8		0.25	6.4	0.64	2.68	68	1.36	34.5	1.26	32
-TCKV-SKF-8-8	1/2/NPT1/2		0.44	11.1	2.20	3.62	92	1.83	46.5	1.50	38

● 100(37°C)时的流量数据 Flow date with the temperature 100(37°C)

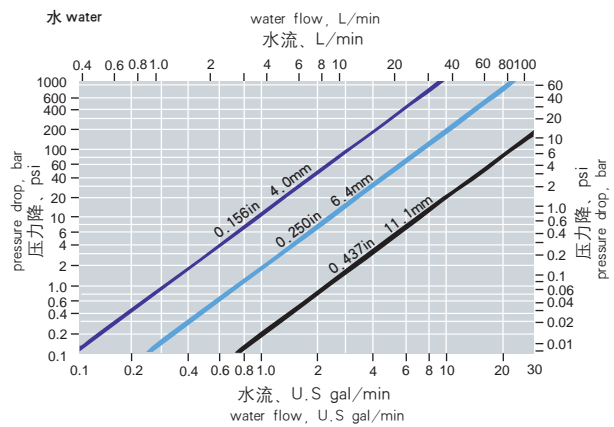
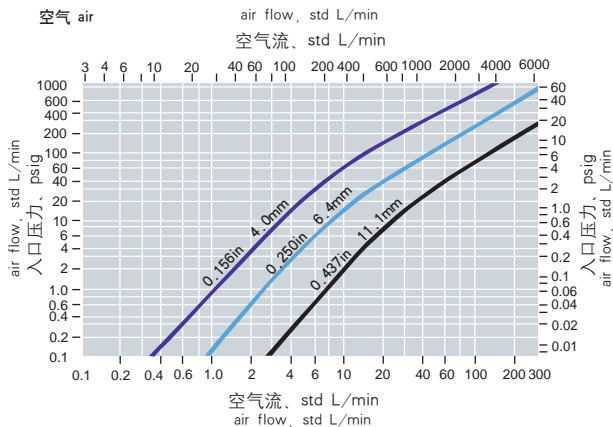

● 订购数据和尺寸 order data and size

选择—订购号 selection—order number
尺寸仅供参考, 可能有变动。The size is only for reference and it might be changeable.

● 特种合金 Special alloy

许多阀体可由其他合金制成。订购时在基本订货号前添加特种合金代号。
Many kinds of valve bodies can be made of other kinds of alloys and add the special alloy code in front of the basic order number while ordering.

● 测试 Test

每个扬中新亚提升单向阀在出厂前都经过试验, 保证能正常工作。
Each lifting non-return valve has been inspected and tested before ex-factory to insure its normal operation.

SINYA

港商 扬中新亚自控工程有限公司
独资 YANGZHONG SINYA AUTO-CONTROL ENGINEERING CO., LTD.

地址：江苏省扬中经济开发区兴隆港北路

Add: Xinglong Port, Yangzhong, Zhenjiang, Jiangsu, China

电话(Tel): 0511-88783806

传真(Fax): 0511-88451691

网址(Http): www.sklok.com

邮箱(E-mail): sales@sklok.com info@sklok.com