



XYG-KK 系列 37° 扩口式接头

XYG - KK 37° Flared tube fittings

SINYA



目录 CONTENT

	06		KK01型套管 Sleeve
	06		-KK02螺母 Nut
	06		-KK03锁紧螺母 Lock Nut
	07		-KKA型异径转换接头 Reducing Connector
	07		-KK6型直通中间接头 Straight Union
	08		-KK1型外螺纹直通终端接头 Male Straight Connector
	08		-KK7型内螺纹直通终端接头 Female Straight Connector
	09		-KK6A型直通中间接头 Straight Union
	09		-KK1A型外螺纹直通终端接头 Male Straight Connector
	10		-KK2型外螺纹弯通终端接头 Male Elbow Connector

	10		-KK8型内螺纹弯通终端接头 Female Elbow Connector
	11		-KK9型弯通中间接头 Elbow Union
	11		-KK3型三通中间接头 Tee Union
	12		-KKTMM型外螺纹支管三通接头 Male Branch Tee
	12		-KKTTF型内螺纹支管三通接头 Female Branch Tee
	13		-KKTMT型外螺纹侧三通接头 Male Side Tee
	13		-KKTFT型内螺纹侧三通接头 Female Side Tee
	14		-KK4型四通中间接头 Cross Union
	14		-KK61型直通穿板接头 Straight Bulkhead
	15		-KKC型管帽 Cap
	15		-KKP型堵头 Plug

订购选型 Ordering Information

扬中新亚公司XYG-KK系列37°管接头为3件式配套件，成套供货，编号由多个符号组成，这些符号代表材料类型，系列号结构形式和端接尺寸具体如下：

XYG-KK 37° tube fitting supplied by Yangzhong Xinya Company is made of three pieces of fittings. The serial number comprises many codes which represent different material codes. The detailed structure type and the end size are shown as following table.



订购样例：代表具有下列特点的KK系列管接头

Example: KK series tube fitting is explained as following:

SS-KK2-6-6	B-KK3-8
①SS=316不锈钢材料 SS	①B=黄铜 Brass
②KK=37°管接头系列号 tube fitting serial code	②KK=37°管接头系列号 tube fitting serial code
③2=结构形式弯通 structure type: elbow	③3=结构形式三通 structure type: Tee
④6=配管端接尺寸3/8"或Φ10 Tube end size: 3/8" or Φ10	④8=配管端接尺寸1/2"或Φ12 Tube end size: 1/2" or Φ12
⑤6=第二端接尺寸NPT3/8"螺纹 No. 2 end size: NPT3/8"	

XYG-KK系列37° 扩口式接头

XYG — KK 37° Flared tube fittings

符合"美国汽车工程师协会标准"

Meet SAE standard J514



如有需要, 请参阅"美国汽车工程师协会标准"第J524部分中的全部尺寸清单。

美国标准锥管螺纹(NPT)符合"美国机械工程师协会标准"或"美国国家标准学会标准第B1.20.1部分(1983年版)(即ASME / ANSI B1.20.1(1983))"中的要求。

如果使用公制37° 套管, 所有37° 扩口式管接头-3件式管道配件, 都可以用来连接公制导管, 无需借助英制套管。每个尺寸表都详细说明了各类尺寸所应选用的公制套管。

If required, see SAE Standard J514 for a complete list of dimensions. NPT Tapered Pipe Threads meet the requirements of ASME/ANSI B.1.20.1.

All 37° Flared tube fittings-3 piece tube assembly, can be used with metric tube by using a metric 37° sleeve, instead of an inch sleeve. Each dimension table shows which metric sleeve should be used for every size.

装配说明

- 1.按适当的长度切割导管。
- 2.把螺母和套管安放到导管上。(参见图1)
- 3.利用特殊的扩口工具, 使喇叭口形成37° 尺寸, 该尺寸符合"美国汽车工程师协会标准"第J533部分。(见第3页)
- 4.把螺母上到接头体上, 用手旋转, 感觉到紧即可。
- 5.从该手动拧紧位置开始, 用扳手把螺母再拧紧1/4圈, 以便使金属连接处形成一个能够防泄漏的金属部分。

Assembly Instructions

1. Cut the tube to the proper length.
2. Slide the nut and sleeve onto the tube. (see figure 1)
3. With a special flaring tool, form the flare to 37° dimension according to SAE Standard J533. (see Page 3)
4. Screw the nut onto the body until finger tight.
5. From this position, tighten the nut with a wrench 1/4" turn in order to make a leakproof metal-to-metal connection.

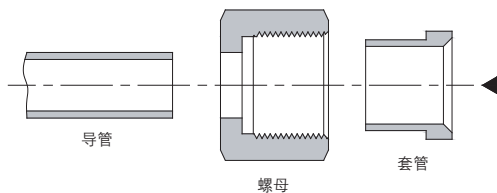


图1

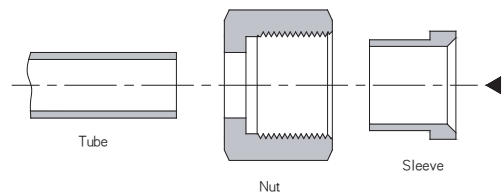


figure 1

三件式37° 扩口管接头的配管数据

为了保证接头的最大可靠性和最佳性能, 在每次为接头选择导管时, 应当格外认真(慎重)。

导管材料应经过充分的退火处理的无缝拉制管材, 适合进行弯曲和扩口加工, 符合"美国试验与材料协会标准"第269部分(ASM-269)以及"美国钢铁学会标准"第316部分或304部分(即A.I.S.I 316或304)。

Tube Data for 37° Flare Three-piece Tube Assembly

In order to ensure maximum fitting reliability and performance, please take great care when selecting the tube for each application. Tubing should be fully annealed, seamless and drawn, suitable for bending and flaring, according to standard ASTM-269, A.I.S.I 316 or 304.

● 管材质量要求

加工后的导管在长度方向上应有适当的直度，端部光滑无毛刺。导管不能有锈迹或污垢，不能有裂纹及刮痕等受损缺陷，表面应足够整洁。只要不超过导管在直径和壁厚方面所容许的偏差，不应把导管表面上诸如搬运标志、模痕或较浅的凹坑等痕迹当作受损缺陷。此类痕迹不需要清除。（参见“美国汽车工程师协会标准”第J524部分关于“质量”的章节即SAE J524—质量）

● 导管的搬运

导管上的刮痕可能会引起泄漏。因此，搬运管材时，应小心轻放，以便减少泄漏的风险，做到这点十分重要。

1. 严禁在地板上拖曳管材。
2. 严禁把管材从管架上拖曳出来，尤其是外径较大的管材，更须禁止如此操作。

● 铜管

如果要成卷的铜管卷盘中取用铜管，应先握住管材的末端然后向外滚动铜管卷盘，让铜管平放在平坦的地面上。

● 导管的切割

切割导管可采用下列两种不同的方法

- 1 切管刀
- 2 弓锯(钢锯)

● 切管刀

要想使接头处的连接不会发生泄漏，导管的切口必须平直。建议使用优质的切管刀，切管刀的刀片应与需要切割的导管材料相适应。

不要为了缩短切割时间而把切管刀的每圈切口切得很深。这样做会使导管出现加工硬化的现象。

必须清理导管末端的毛刺，以免对管接头造成损坏，同时，这样做还可以保证导管能够达到接头的底部。

● 弓锯(钢锯)切割

使用弓锯(钢锯)切割导管时，要想获得平直的管端，必须使用锯管导向块。这种切割方法需要清理导管末端的毛刺。

● 警告

不要用老虎钳夹持导管将要插入接头中的部位(老虎钳会在导管上造成伤痕，该伤痕可能会导致泄漏，还可能使导管变成椭圆形)。

● Quality Requirement

Lengths of finished tubing should be reasonably straight and have smooth ends, free from burrs. Tubing should be free from scale and injurious defects, and it should have a workmanlike finish. Surface imperfections such as handling marks, die marks, or shallow pits will not be considered injurious defects provided the imperfections are within the tolerances specified for diameter and wall thickness. The removal of such imperfections is not required.(Quality SAE J524).

● Tube Handling

Scratches on the tube might cause leaks. It is, therefore, important to handle the tube carefully to reduce the risk of leaks.

1. Tubes must not be dragged on the floor.
2. Tubes must not be dragged out of a tubing rack, especially in cases of large OD tubes

● Copper Tube

If using copper tubing from a roll, hold the end of the tube and roll the roll outwards allowing the tubing to lie on a flat surface.

● Tube Cutting

Two different methods can be used to cut tubes.

1. Tube cutter
2. Hacksaw

● Tube Cutter

To attain a leak free connection, the tubing must be cut squarely. A good quality tube cutter with the appropriate blade for the tubing material is recommended.

Don't try to reduce the time of cutting by taking deep cuts with each turn of the cutter. This will work harden the tube.

The end of the tube must be deburred to avoid damage to the fitting and to ensure that the tube reaches the bottom of the fitting.

● Hacksaw Cutting

In order to cut the tube with a hacksaw and get square ends, the tube must be cut with guide blocks. This method of cutting necessitates deburring of the tube ends.

● Warning

Don't hold the tube in a vise in the place where it will be inserted into the fitting (the vise will leave a mark on the tube that may cause leaks and might cause ovality.).

XYG-KK系列37° 扩口式接头



XYG — KK 37° Flared tube fittings

● 装配说明 Assembly Instructions

进行扩口加工，扩口加工要求符合“美国汽车工程师协会标准”第J533部分，即SAE J533，参见图2。
Perform flaring according to SAE J533. See Fig.2. See Table 1 below for dimensions.

表1：扩口 Table 1: Flaring

导管 Tube 公称外径 Nominal OD	A 单喇叭口直径 Single Flare Diameter				R		S	
	英寸 in		毫米 mm		英寸in	毫米mm	英寸in	毫米mm
	最大max	最小min	最大max	最小min	±0.02	±0.05	最大max	最小min
1/8	0.20	0.18	5.08	4.58	0.03	0.8	0.035	0.88
3/16	0.28	0.26	7.11	6.61	0.03	0.8	0.035	0.88
1/4	0.36	0.34	9.14	8.64	0.03	0.8	0.065	1.65
5/16	0.43	0.40	10.92	10.16	0.04	0.8	0.065	1.65
3/8	0.49	0.46	12.44	11.69	0.06	1.0	0.65	1.65
1/2	0.66	0.63	16.76	16.01	0.06	1.5	0.083	2.1
5/8	0.79	0.76	20.06	19.31	0.06	1.5	0.095	2.41
3/4	0.95	0.92	24.13	23.37	0.08	2.0	0.109	2.79
7/8	1.07	1.04	27.17	26.42	0.08	2.0	0.109	2.79
1	1.20	1.17	30.48	29.72	0.09	2.3	0.12	3.04
1-1/8	1.38	1.35	35.05	34.29	0.09	2.3	0.12	3.04
1-1/4	1.51	1.48	38.35	37.60	0.09	2.3	0.12	3.04
1-1/2	1.73	1.70	43.94	43.18	0.11	2.8	0.12	3.04

上述尺寸数据仅供参考，如有变更恕不另行通知。
Dimensions are for reference only and subject to change without notice.

表2：容许工作压力额定值(能够承受至少4分钟到1分钟的爆裂压力)
Table 2: Allowable Working Pressure Ratings (Capable of 4" to 1" min burst)

符合“美国汽车工程师协会标准 (SAE) ”的公称零件尺寸 Nom. SAE Dash Size	公称导管外径 Nom. Tube OD	37° 喇叭口直螺纹 37° Flare Straight thread	公称导管尺寸 Nom. Pipe Size	符合“美国汽车工程师协会标准 (SAE) ”的内外螺纹活管接及穿板接头 SEA St. Threads Union & Bulkhead	带有管螺纹的街头 Fittings with Pipe Threads
2	1/8	5/16-24	1/8	5000	5000
3	3/16	3/8-24	1/8	5000	5000
4	1/4	7/16-20	1/8	5000	5000
5	5/16	1/2-20	1/8	5000	5000
6	3/8	9/16-18	1/4	5000	5000
8	1/2	3/4-16	3/8	4500	4000
10	5/8	7/8-14	1/2	3500	3000
12	3/4	1 1/16-12	3/4	3500	3000
14	7/8	1 3/16-12	3/4	3000	2500
16	1	1 5/16-12	1	3000	2000
20	1-1/4	1 5/8-12	1 1/4	2500	1150
24	1-1/2	1 7/8-12	1 1/2	2000	1000
32	2	2 1/2-12	2	1500	1000

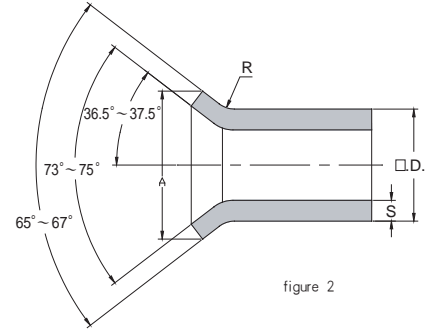


figure 2

扩口加工之前应进行管端毛刺清理 Deburring Prior To Flaring

为了能够获得令人满意的喇叭口，在进行扩口操作之前，可能需要清理导管末端的毛刺。在单扩口操作之前，通常要把导管的内棱角打磨成圆滑状；对于某些有色金属导管，通常要求清除切割后留下的毛刺，否则，这些毛刺可能会造成贯穿喇叭口关键部位的泄漏途径。对于任何类型材料的导管，在进行单扩口操作之前，也提倡把导管的外棱角打磨成光滑状，或者，在进行双扩口操作之前，把内、外棱角都打磨成光滑状，这样做，才能够把出现裂缝的可能性降低到最小的程度。

To ensure satisfactory flares are produced, it may be necessary to deburr the tube end prior to flaring. It is usually necessary to break the inside corner smoothly before single flaring, and some non-ferrous tubing to eliminate is normally required to eliminate the cutoff burr which might otherwise create leakage paths across a substantial portion of the flare. It is acceptable to smoothly break the outside corner prior to single flaring, or both outside and inside corners prior to double flaring, on any tube material to minimize splitting.

说明:

由于管道系统的正常或非正常工作压力受到许多因素的影响，所以，不应把表2内的数值当作最小保证值。

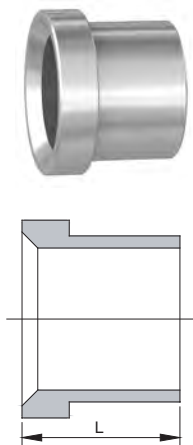
Note:

Since many factors influence the pressure at which a system will or will not perform satisfactorily values shown in Table 2 should not be construed as guaranteed minimum.

● -KK01型套管 Sleeve

英制套管 British Sleeve

公制套管 British Sleeve



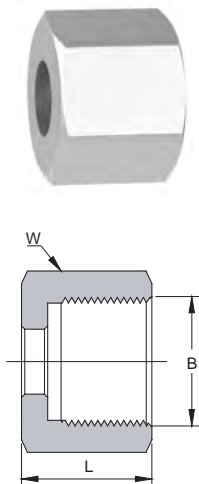
基本订货号 Order information	导管外径 Tubing OD	L	
		英寸 (in)	毫米 (mm)
-KK01-2	1/8	0.34	8.6
-KK01-3	3/16	0.34	8.6
-KK01-4	1/4	0.41	10.4
-KK01-5	5/16	0.44	11.2
-KK01-6	3/8	0.50	12.7
-KK01-8	1/2	0.56	14.2
-KK01-10	5/8	0.66	16.8
-KK01-14	3/4	0.68	17.3
-KK01-12	7/8	0.76	19.3
-KK01-16	1	0.78	19.8
-KK01-20	1 1/4	0.91	23.1
-KK01-24	1 1/2	1.12	28.4
-KK01-32	2	1.19	30.2

基本订货号 Order information	导管外径 Tubing OD	L	
		英寸 (in)	毫米 (mm)
-	-	-	-
-	-	-	-
-KK01-6mm	6		10.4
-KK01-8mm	8		11.2
-KK01-10mm	10		12.7
-KK01-12mm	12		14.2
-KK01-16mm	16		16.8
-KK01-18mm	18		17.3
-KK01-20mm	20		19.3
-KK01-25mm	25		19.8
-KK01-32mm	32		23.1
-KK01-38mm	38		28.4

公制套管和标准螺母及接头体配套使用。

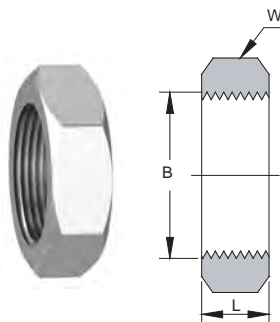
All 37° flared tube fittings can be used with metric tube by using a metric 37° sleeve. Each dimension table shows which metric sleeve can be used for every size.

● -KK02螺母 Nut



基本订货号 Order information	导管外径 Tubing OD		B (UNF)	W 英寸 (in)	L	
	英寸 (in)	毫米 (mm)			英寸 (in)	毫米 (mm)
-KK02-2	1/8	-	5/6-24	3/8	0.54	13.7
-KK02-3	3/16	-	3/8-24	7/16	0.60	15.2
-KK02-4-6mm	1/4	6	7/16-20	9/16	0.61	15.5
-KK02-5-8mm	5/16	8	1/2-20	5/8	0.67	17.0
-KK02-6-10mm	3/8	10	9/16-18	11/16	0.72	18.3
-KK02-8-12mm	1/2	12	3/4-16	7/8	0.84	21.3
-KK02-10-16mm	5/8	16	7/8-14	1	0.97	24.6
-KK02-12-18mm	3/4	18	1 1/16-12	1 1/4	1.02	25.9
-KK02-14-20mm	7/8	20	1 3/16-12	1 3/8	1.08	27.4
-KK02-16-25mm	1	25	1 5/16-12	1 1/2	1.12	28.4
-KK02-20-32mm	1 1/4	32	1 5/8-12	2	1.22	31.0
-KK02-24-38mm	1 1/2	38	1 7/8-12	2 1/4	1.41	35.8
-KK02-32	2	-	2 1/2-12	2 7/8	1.74	44.2

● -KK03锁紧螺母 Lock nut

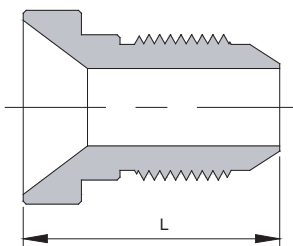


基本订货号 Order information	导管外径 Tubing OD		B (UNF)	W 英寸 (in)	L	
	英寸 (in)	毫米 (mm)			英寸 (in)	毫米 (mm)
-KK03-3/8-24	3/16	-	3/8-24	5/8	0.22	5.6
-KK03-7/16-20	1/4	6	7/16-20	11/16	0.25	6.4
-KK03-1/2-20	5/16	8	1/2-20	3/4	0.25	6.4
-KK03-9/16-18	3/8	10	9/16-18	13/16	0.27	6.9
-KK03-3/4-16	1/2	12	3/4-16	1	0.31	7.9
-KK03-7/8-14	5/8	16	7/8-14	11/8	0.36	9.1
-KK03-11/16-12	3/4	18	1 1/16-12	13/8	0.41	10.4
-KK03-13/16-12	7/8	20	1 3/16-12	11/2	0.41	10.4
-KK03-15/16-12	1	25	1 5/16-12	15/8	0.41	10.4
-KK03-15/8-12	1 1/4	32	1 5/8-12	17/8	0.41	10.4
-KK03-17/8-12	1 1/2	38	1 7/8-12	21/8	0.41	10.4
-KK03-11/2-12	2	-	2 1/2-12	23/4	0.41	10.4

XYG-KK系列37° 扩口式接头

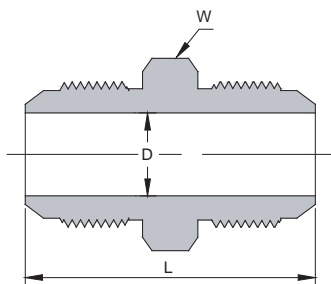
XYG — KK 37° Flared tube fittings

● -KKA型异径转换接头 Reducing Connector



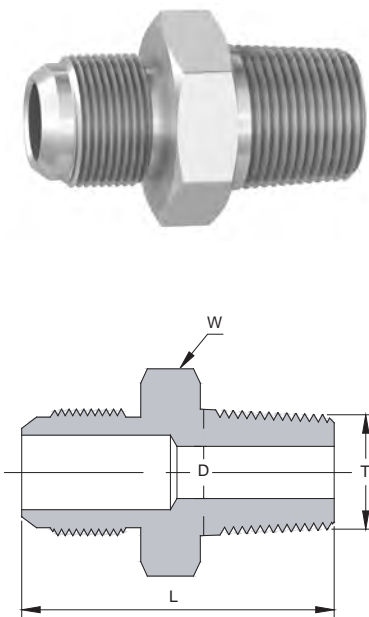
基本订货号 Order information	导管外径Tubing OD		L	
	英寸 (in)	毫米 (mm)	英寸 (in)	毫米 (mm)
KKA-6-4	3/8 to 1/4	3/8 to 6	0.97	24.6
KKA-8-4	1/2 to 1/4	1/2 to 6	1.00	25.4
KKA-8-6	1/2 to 3/8	1/2 to 10	1.00	25.4
KKA-10-4	5/8 to 1/4	5/8 to 6	1.03	26.2
KKA-10-6	5/8 to 3/8	5/8 to 10	1.03	26.2
KKA-10-8	5/8 to 1/2	5/8 to 12	1.44	36.5
KKA-12-4	3/4 to 1/4	3/4 to 6	1.09	27.7
KKA-12-6	3/4 to 3/8	3/4 to 10	1.09	27.7
KKA-12-8	3/4 to 1/2	3/4 to 12	1.19	30.2
KKA-12-10	3/4 to 5/8	3/4 to 16	1.66	42.1
KKA-14-6	7/8 to 3/8	7/8 to 10	1.13	28.7
KKA-14-10	7/8 to 5/8	7/8 to 16	1.33	33.7
KKA-14-12	7/8 to 3/4	7/8 to 18	1.84	46.7
KKA-16-12	1 to 3/4	1 to 18	1.47	37.3
KKA-16-14	1 to 7/8	1 to 20	1.91	48.5
KKA-20-12	1 1/4 to 3/4	1 1/4 to 18	1.53	38.8
KKA-20-16	1 1/4 to 1	1 1/4 to 25	1.59	40.3
KKA-24-20	1 1/2 to 1 1/4	1 1/2 to 32	1.69	42.9

● -KK6型直通中间接头 Straight Union



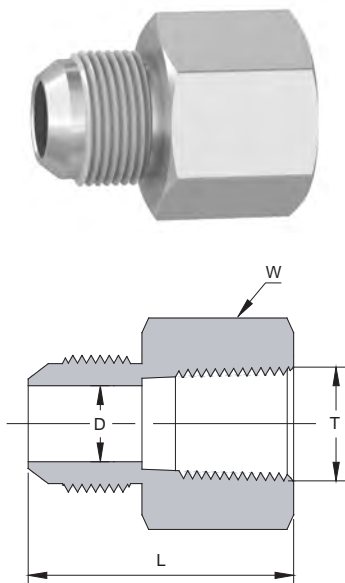
基本订货号 Order information	导管外径Tubing OD		D		W	L	
	英寸 (in)	毫米 (mm)	英寸 (in)	毫米 (mm)	英寸 (in)	英寸 (in)	毫米 (mm)
-KK6-2	1/8	—	0.062	1.6	7/16	1.17	29.7
-KK6-3	3/16	—	0.125	3.2	7/16	1.23	31.2
-KK6-4	1/4	6	0.172	4.4	1/2	1.37	34.8
-KK6-5	5/16	8	0.234	6.0	9/16	1.37	34.8
-KK6-6	3/8	10	0.297	7.5	5/8	1.41	35.8
-KK6-8	1/2	12	0.391	9.9	13/16	1.62	41.1
-KK6-10	5/8	16	0.484	12.3	15/16	1.88	47.8
-KK6-12	3/4	18	0.609	15.5	1 1/8	2.16	54.9
-KK6-14	7/8	20	0.719	18.3	1 1/4	2.21	56.1
-KK6-16	1	25	0.844	21.5	1 3/8	2.25	57.2
-KK6-20	1 1/4	32	1.078	27.5	1 11/16	2.43	61.7
-KK6-24	1 1/2	38	1.312	33.0	2	2.75	69.8
-KK6-32	2	—	1.781	45.0	2 5/8	3.04	86.4

● -KK1型外螺纹直通终端接头 Male Straight Connector



基本订货号 Order information	导管外径Tubing OD		T (NPT)	D		W	L	
	英寸(in)	毫米(mm)		英寸(in)	毫米(mm)		英寸(in)	英寸(in)
-KK1-2-2	1/8	—	1/8	0.062	1.6	7/16	1.11	28.2
-KK1-3-2	3/16	—	1/8	0.125	3.2	7/16	1.14	29.0
-KK1-4-2	1/4	6	1/8	0.172	4.4	1/2	1.22	31.0
-KK1-4-4	1/4	6	1/4	0.172	4.4	9/16	1.42	36.0
-KK1-4-8	1/4	6	1/2	0.172	4.4	7/8	1.68	42.7
-KK1-5-2	5/16	8	1/8	0.190	4.8	9/16	1.22	31.0
-KK1-5-4	5/16	8	1/4	0.234	6.0	9/16	1.42	36.1
-KK1-6-2	3/8	10	1/8	0.190	4.8	5/8	1.25	31.8
-KK1-6-4	3/8	10	1/4	0.280	7.1	5/8	1.43	36.3
-KK1-6-6	3/8	10	3/8	0.297	7.5	3/4	1.43	36.3
-KK1-6-8	3/8	10	1/2	0.297	7.5	7/8	1.69	42.5
-KK1-8-4	1/2	12	1/4	0.280	7.1	13/16	1.53	38.9
-KK1-8-6	1/2	12	3/8	0.380	9.5	13/16	1.53	38.9
-KK1-8-8	1/2	12	1/2	0.391	9.9	7/8	1.79	45.4
-KK1-8-12	1/2	12	3/4	0.391	9.9	11/8	1.85	47.0
-KK1-10-6	5/8	16	3/8	0.380	9.5	15/16	1.70	43.1
-KK1-10-8	5/8	16	1/2	0.470	11.9	15/16	1.89	48.0
-KK1-10-12	5/8	16	3/4	0.484	12.3	11/8	1.95	49.5
-KK1-12-12	3/4	18	3/4	0.609	15.5	11/8	2.06	52.3
-KK1-12-16	3/4	18	1	0.609	15.5	13/8	2.25	57.1
-KK1-14-12	7/8	20	3/4	0.719	18.3	11/4	2.09	53.1
-KK1-16-12	1	25	3/4	0.719	18.3	13/8	2.11	53.5
-KK1-16-16	1	25	1	0.844	21.5	13/8	2.30	58.4
-KK1-20-16	1 1/4	32	1	0.844	21.5	1 11/16	2.42	61.5
-KK1-20-20	1 1/4	32	1 1/4	1.078	27.5	1 11/16	2.45	62.2
-KK1-24-20	1 1/2	38	1 1/4	1.312	33.0	2	2.68	68.1
-KK1-24-24	1 1/2	38	1 1/2	1.312	33.0	2	2.68	68.1
-KK1-32-32	2	—	2	1.781	45.0	2 5/8	3.11	79.0

● -KK7型内螺纹直通终端接头 Female Straight Connector

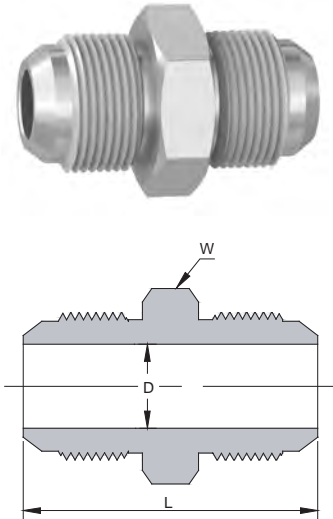


基本订货号 Order information	导管外径Tubing OD		T (NPT)	D		W	L	
	英寸(in)	毫米(mm)		英寸(in)	毫米(mm)		英寸(in)	英寸(in)
-KK7-2-2	1/8	—	1/8	0.062	1.6	9/16	1.12	28.4
-KK7-3-2	3/16	—	1/8	0.125	3.2	9/16	1.13	28.7
-KK7-4-2	1/4	6	1/8	0.172	4.4	9/16	1.19	30.2
-KK7-4-4	1/4	6	1/4	0.172	4.4	3/4	1.39	35.3
-KK7-5-2	5/16	8	1/8	0.234	6.0	9/16	1.17	29.7
-KK7-5-4	5/16	8	1/4	0.234	6.0	3/4	1.39	35.3
-KK7-6-4	3/8	10	1/4	0.297	7.5	3/4	1.40	35.6
-KK7-6-6	3/8	10	3/8	0.297	7.5	7/8	1.46	37.1
-KK7-8-6	1/2	12	3/8	0.391	9.9	7/8	1.56	39.6
-KK7-8-8	1/2	12	1/2	0.391	9.9	11/8	1.79	45.6
-KK7-10-8	5/8	16	1/2	0.484	12.3	11/8	1.89	48.0
-KK7-12-8	3/4	18	1/2	0.609	15.5	11/8	2.05	52.1
-KK7-12-12	3/4	18	3/4	0.609	15.5	13/8	2.06	52.3
-KK7-14-12	7/8	20	3/4	0.719	18.3	13/8	2.06	52.3
-KK7-16-16	1	25	1	0.844	21.5	1 5/8	2.35	59.7
-KK7-20-20	1 1/4	32	1 1/4	1.078	27.5	2	2.49	63.2
-KK7-24-24	1 1/2	38	1 1/2	1.312	33.0	2 3/8	2.62	66.5
-KK7-32-32	2	—	2	1.781	45.0	2 7/8	2.97	75.4

XYG-KK系列37° 扩口式接头

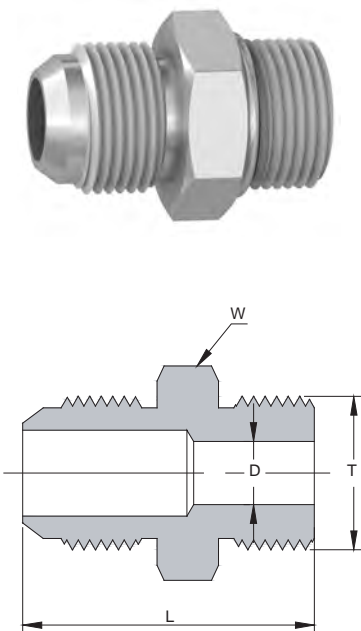
XYG — KK 37° Flared tube fittings

● -KK6A型直通中间接头 Straight Union



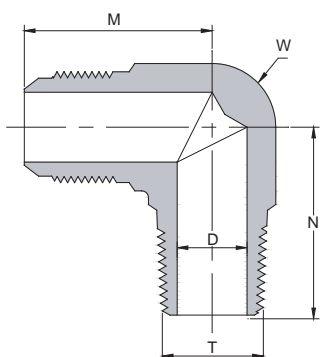
基本订货号 Order information	导管外径Tubing OD		D		W	L	
	英寸 (in)	毫米 (mm)	英寸 (in)	毫米 (mm)	英寸 (in)	英寸 (in)	毫米 (mm)
-KK6A-2	1/8	—	0.062	1.6	9/16	1.17	29.7
-KK6A-3	3/16	—	0.125	3.2	5/8	1.23	31.2
-KK6A-4	1/4	6	0.172	4.4	11/16	1.37	34.8
-KK6A-5	5/16	8	0.234	6.0	3/4	1.37	34.8
-KK6A-6	3/8	10	0.297	7.5	13/16	1.41	35.8
-KK6A-8	1/2	12	0.391	9.9	1	1.62	41.1
-KK6A-10	5/8	16	0.484	12.3	1 1/8	1.88	47.8
-KK6A-12	3/4	18	0.609	15.5	1 3/8	2.16	54.9
-KK6A-14	7/8	20	0.719	18.3	1 1/2	2.21	56.1
-KK6A-16	1	25	0.844	21.5	1 5/8	2.25	57.2
-KK6A-20	1 1/4	32	1.078	27.5	1 7/8	2.43	61.7
-KK6A-24	1 1/2	38	1.312	33.0	2 1/8	2.75	69.8
-KK6A-32	2	—	1.781	45.0	2 3/4	3.04	86.4

● -KK1A型外螺纹直通终端接头 Male Straight



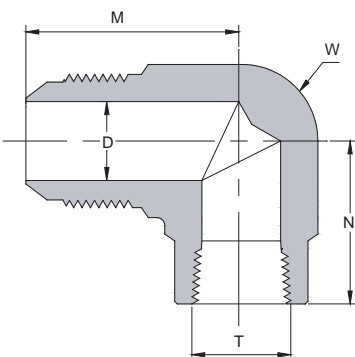
基本订货号 Order information	导管外径Tubing OD		T	D		W	L	
	英寸 (in)	毫米 (mm)	(NPT)	英寸 (in)	毫米 (mm)	英寸 (in)	英寸 (in)	毫米 (mm)
-KK1A-2-5/16-24	1/8	—	5/16-24	0.062	1.6	7/16	1.06	26.9
-KK1A-3-3/8-24	3/16	—	3/8-24	0.125	3.2	1/2	1.10	27.9
-KK1A-4-7/16-20	1/4	6	7/16-20	0.172	4.4	9/16	1.23	31.2
-KK1A-4-1/2-20	1/4	6	1/2-20	0.172	4.4	5/8	1.23	31.2
-KK1A-4-9/16-18	1/4	6	9/16-18	0.172	4.4	11/16	1.30	33.0
-KK1A-4-3/4-16	1/4	6	3/4-16	0.172	4.4	7/8	1.37	34.8
-KK1A-5-1/2-20	5/16	8	1/2-20	0.234	6.0	5/8	1.23	31.2
-KK1A-6-9/16-18	3/8	10	9/16-18	0.280	7.1	11/16	1.30	33.0
-KK1A-6-3/4-16	3/8	10	3/4-16	0.297	7.5	7/8	1.38	35.1
-KK1A-6-7/8-14	3/8	10	7/8-14	0.297	7.5	1	1.50	38.1
-KK1A-8-3/4-16	1/2	12	3/4-16	0.391	9.9	7/8	1.48	37.6
-KK1A-8-9/16-18	1/2	12	9/16-18	0.280	9.9	13/16	1.44	36.6
-KK1A-8-7/8-14	1/2	12	7/8-14	0.391	9.9	1	1.60	40.6
-KK1A-8-11/16-12	1/2	12	11/16-12	0.391	9.9	11/4	1.76	44.7
-KK1A-10-7/8-14	5/8	16	7/8-14	0.484	12.3	1	1.70	43.2
-KK1A-10-3/4-16	5/8	16	3/4-16	0.484	12.3	15/16	1.60	40.6
-KK1A-10-11/16-12	5/8	16	11/16-12	0.484	12.3	1 1/4	1.86	47.2
-KK1A-12-11/16-12	3/4	18	11/16-12	0.609	15.5	1 1/4	1.97	50.0
-KK1A-12-3/4-16	3/4	18	3/4-16	0.420	10.7	1 1/8	1.78	45.2
-KK1A-12-7/8-14	3/4	18	7/8-14	0.500	12.7	1 1/8	1.83	46.4
-KK1A-12-15/16-12	3/4	18	15/16-12	0.609	15.5	1 1/2	2.00	50.8
-KK1A-14-13/16-12	7/8	20	13/16-12	0.719	18.3	1 3/8	1.99	50.5
-KK1A-14-15/16-12	7/8	20	15/16-12	0.719	18.3	1 1/2	2.02	51.3
-KK1A-16-15/16-12	1	25	15/16-12	0.844	21.5	1 1/2	2.04	51.8
-KK1A-16-11/16-12	1	25	11/16-12	0.650	16.7	1 3/8	2.01	51.1
-KK1A-16-13/16-12	1	25	13/16-12	0.719	18.3	1 3/8	2.04	51.8

● -KK2型外螺纹弯通终端接头 Male Elbow Connector



基本订货号 Order information	导管外径Tubing OD		T (NPT)	D		W 英寸 (in)	M		N	
	英寸 (in)	毫米 (mm)		英寸 (in)	毫米 (mm)		英寸 (in)	毫米 (mm)	英寸 (in)	毫米 (mm)
-KK2-2-2	1/8	-	1/8	0.062	1.6	7/16	0.77	19.6	0.72	18.3
-KK2-3-2	3/16	-	1/8	0.125	3.2	1/2	0.83	21.1	0.72	18.3
-KK2-4-2	1/4	6	1/8	0.172	4.4	1/2	0.89	22.6	0.78	19.8
-KK2-4-4	1/4	6	1/4	0.172	4.4	5/8	1.06	26.9	1.09	27.7
-KK2-5-2	5/16	8	1/8	0.190	4.8	5/8	0.95	24.1	0.78	19.8
-KK2-5-4	5/16	8	1/4	0.234	6.0	5/8	1.06	26.9	1.09	27.7
-KK2-6-2	3/8	10	1/8	0.190	4.8	5/8	1.06	26.9	0.90	22.8
-KK2-6-4	3/8	10	1/4	0.280	7.1	5/8	1.06	26.9	1.09	27.7
-KK2-6-6	3/8	10	3/8	0.297	7.5	13/16	1.14	29.0	1.22	31.0
-KK2-6-8	3/8	10	1/2	0.297	7.5	15/16	1.23	31.2	1.47	37.3
-KK2-8-4	1/2	12	1/4	0.280	7.1	15/16	1.25	31.8	1.22	31.0
-KK2-8-6	1/2	12	3/8	0.380	9.5	15/16	1.25	31.8	1.22	31.0
-KK2-8-8	1/2	12	1/2	0.391	9.9	15/16	1.33	33.7	1.47	37.3
-KK2-8-12	1/2	12	3/4	0.391	9.9	11/8	1.42	36.0	1.59	40.4
-KK2-10-6	5/8	16	3/8	0.380	9.5	15/16	1.45	36.8	1.30	33.0
-KK2-10-8	5/8	16	1/2	0.470	11.9	15/16	1.45	36.8	1.47	37.3
-KK2-10-12	5/8	16	3/4	0.484	12.3	11/8	1.53	38.9	1.59	40.4
-KK2-12-8	3/4	18	1/2	0.470	11.9	11/8	1.66	41.0	1.59	40.4
-KK2-12-12	3/4	18	3/4	0.609	15.5	11/8	1.66	41.0	1.59	40.4
-KK2-14-12	7/8	20	3/4	0.719	18.3	13/8	1.73	43.9	1.69	42.9
-KK2-16-12	1	25	3/4	0.719	18.3	13/8	1.81	46.0	1.78	45.2
-KK2-16-16	1	25	1	0.844	21.5	13/8	1.81	46.0	1.97	50.0
-KK2-20-16	1 1/4	32	1	0.844	21.5	1 1/16	2.06	52.3	2.35	59.6
-KK2-20-20	1 1/4	32	1 1/4	1.078	27.5	1 1/16	2.06	52.3	2.38	60.5
-KK2-24-24	1 1/2	38	1 1/2	1.312	33.0	2	2.33	59.2	2.64	67.1
-KK2-32-32	2	-	2	1.781	45.0	2 5/8	3.06	77.7	3.00	76.2

● -KK8型内螺纹弯通终端接头 Female Elbow Connector

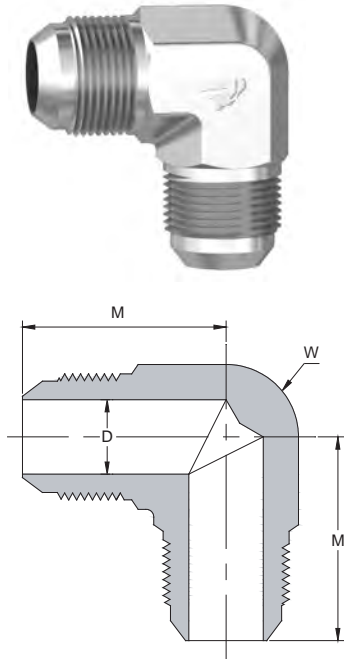


基本订货号 Order information	导管外径Tubing OD		T (NPT)	D		W 英寸 (in)	M		N	
	英寸 (in)	毫米 (mm)		英寸 (in)	毫米 (mm)		英寸 (in)	毫米 (mm)	英寸 (in)	毫米 (mm)
-KK8-2-2	1/8	-	1/8	0.062	1.6	5/8	1.00	25.4	0.66	16.8
-KK8-3-2	3/16	-	1/8	0.125	3.2	5/8	1.03	26.2	0.66	16.8
-KK8-4-2	1/4	6	1/8	0.172	4.4	5/8	1.08	27.4	0.66	16.8
-KK8-4-4	1/4	6	1/4	0.172	4.4	13/16	1.22	30.9	0.88	22.4
-KK8-5-2	5/16	8	1/8	0.234	6.0	5/8	1.08	27.4	0.66	16.8
-KK8-5-4	5/16	8	1/4	0.234	6.0	13/16	1.22	30.9	0.88	22.4
-KK8-6-2	3/8	10	1/8	0.297	7.5	5/8	1.06	26.9	0.66	16.8
-KK8-6-4	3/8	10	1/4	0.297	7.5	13/16	1.23	31.2	0.88	22.4
-KK8-6-6	3/8	10	3/8	0.297	7.5	15/16	1.31	33.2	1.02	25.9
-KK8-8-4	1/2	12	1/4	0.391	9.9	13/16	1.25	31.6	0.88	22.4
-KK8-8-6	1/2	12	3/8	0.391	9.9	15/16	1.42	36.1	1.02	25.9
-KK8-8-8	1/2	12	1/2	0.391	9.9	11/8	1.42	36.1	1.23	31.2
-KK8-10-8	5/8	16	1/2	0.484	12.3	11/8	1.64	41.5	1.23	31.2
-KK8-12-8	3/4	18	1/2	0.609	15.5	13/8	1.66	42.1	1.23	31.2
-KK8-12-12	3/4	18	3/4	0.609	15.5	13/8	1.89	48.0	1.36	34.5
-KK8-14-12	7/8	20	3/4	0.719	18.3	13/8	1.86	47.2	1.42	36.1
-KK8-16-16	1	25	1	0.844	21.5	15/8	2.17	55.1	1.62	41.1
-KK8-20-20	1 1/4	32	1 1/4	1.078	27.5	21/8	2.33	59.2	1.70	43.2
-KK8-24-24	1 1/2	38	1 1/2	1.312	33.0	23/8	2.89	73.4	2.08	52.8
-KK8-32-32	2	-	2	1.781	45.0	27/8	3.30	83.8	2.39	60.7

XYG-KK系列37° 扩口式接头

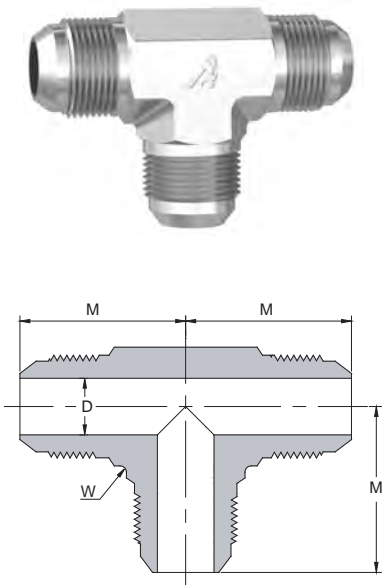
XYG — KK 37° Flared tube fittings

● -KK9型弯通中间接头 Union Elbow



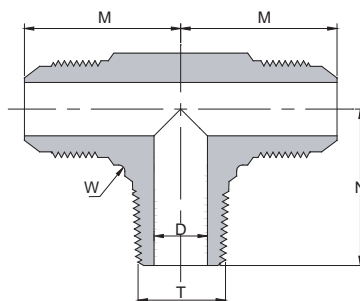
基本订货号 Order information	导管外径Tubing OD		D		W	M	
	英寸 (in)	毫米 (mm)	英寸 (in)	毫米 (mm)	英寸 (in)	英寸 (in)	毫米 (mm)
-KK9-2	1/8	—	0.062	1.6	7/16	0.77	19.6
-KK9-3	3/16	—	0.125	3.2	1/2	0.83	21.1
-KK9-4	1/4	6	0.172	4.4	1/2	0.89	22.6
-KK9-5	5/16	8	0.234	6.0	5/8	0.95	24.1
-KK9-6	3/8	10	0.297	7.5	5/8	1.06	26.9
-KK9-8	1/2	12	0.391	9.9	15/16	1.25	31.8
-KK9-10	5/8	16	0.484	12.3	15/16	1.45	36.8
-KK9-12	3/4	18	0.609	15.5	1 3/8	1.66	42.2
-KK9-14	7/8	20	0.719	18.3	1 3/8	1.80	45.7
-KK9-16	1	25	0.844	21.5	1 3/8	1.81	46.0
-KK9-20	1 1/4	32	1.078	27.5	1 11/16	2.06	52.3
-KK9-24	1 1/2	38	1.312	33.0	2	2.33	59.2
-KK9-32	2	—	1.781	45.0	2 5/8	3.06	77.7

● -KK3型三通中间接头 Union Tee



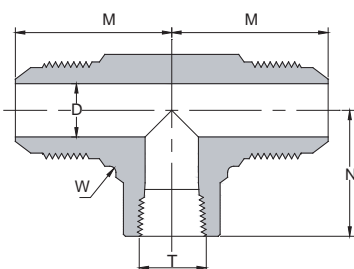
基本订货号 Order information	导管外径Tubing OD		D		W	M	
	英寸 (in)	毫米 (mm)	英寸 (in)	毫米 (mm)	英寸 (in)	英寸 (in)	毫米 (mm)
-KK3-2	1/8	—	0.062	1.6	7/16	0.77	19.6
-KK3-3	3/16	—	0.125	3.2	1/2	0.83	21.1
-KK3-4	1/4	6	0.172	4.4	1/2	0.89	22.6
-KK3-5	5/16	8	0.234	6.0	5/8	0.95	24.1
-KK3-6	3/8	10	0.297	7.5	5/8	1.06	26.9
-KK3-8	1/2	12	0.391	9.9	15/16	1.25	31.8
-KK3-10	5/8	16	0.484	12.3	15/16	1.45	36.8
-KK3-12	3/4	18	0.609	15.5	1 3/8	1.66	42.2
-KK3-14	7/8	20	0.719	18.3	1 3/8	1.80	45.7
-KK3-16	1	25	0.844	21.5	1 3/8	1.81	46.0
-KK3-20	1 1/4	32	1.078	27.5	1 11/16	2.06	52.3
-KK3-24	1 1/2	38	1.312	33.0	2	2.33	59.2
-KK3-32	2	—	1.781	45.0	2 5/8	3.06	77.7

● -KKTMM型外螺纹支管三通接头 Male Branch Tee



基本订货号 Order information	导管外径Tubing OD		T (NPT)	D		W 英寸 (in)	M		N	
	英寸 (in)	毫米 (mm)		英寸 (in)	毫米 (mm)		英寸 (in)	毫米 (mm)	英寸 (in)	毫米 (mm)
-KKTMM-2-2	1/8	—	1/8	0.062	1.6	7/16	0.77	19.6	0.72	18.3
-KKTMM-3-2	3/16	—	1/8	0.125	3.2	1/2	0.83	21.1	0.72	18.3
-KKTMM-4-2	1/4	6	1/8	0.172	4.4	1/2	0.89	22.6	0.78	19.8
-KKTMM-4-4	1/4	6	1/4	0.172	4.4	5/8	1.06	26.9	1.09	27.7
-KKTMM-5-2	5/16	8	1/8	0.190	4.8	5/8	0.95	24.1	0.78	19.8
-KKTMM-5-4	5/16	8	1/4	0.234	6.0	5/8	1.06	26.9	1.09	27.7
-KKTMM-6-2	3/8	10	1/8	0.190	4.8	5/8	1.06	26.9	0.90	22.8
-KKTMM-6-4	3/8	10	1/4	0.280	7.1	5/8	1.06	26.9	1.09	27.7
-KKTMM-6-6	3/8	10	3/8	0.297	7.5	13/16	1.14	29.0	1.22	31.0
-KKTMM-6-8	3/8	10	1/2	0.297	7.5	15/16	1.23	31.2	1.47	37.3
-KKTMM-8-4	1/2	12	1/4	0.280	7.1	15/16	1.25	31.8	1.22	31.0
-KKTMM-8-6	1/2	12	3/8	0.380	9.5	15/16	1.25	31.8	1.22	31.0
-KKTMM-8-8	1/2	12	1/2	0.391	9.9	15/16	1.33	33.7	1.47	37.3
-KKTMM-8-12	1/2	12	3/4	0.391	9.9	11/8	1.42	36.0	1.59	40.4
-KKTMM-10-6	5/8	16	3/8	0.380	9.5	15/16	1.45	36.8	1.30	33.0
-KKTMM-10-8	5/8	16	1/2	0.470	11.9	15/16	1.45	36.8	1.47	37.3
-KKTMM-10-12	5/8	16	3/4	0.484	12.3	11/8	1.53	38.9	1.59	40.4
-KKTMM-12-8	3/4	18	1/2	0.470	11.9	11/8	1.66	41.0	1.59	40.4
-KKTMM-12-12	3/4	18	3/4	0.609	15.5	11/8	1.66	41.0	1.59	40.4
-KKTMM-14-12	7/8	20	3/4	0.719	18.3	13/8	1.73	43.9	1.69	42.9
-KKTMM-16-12	1	25	3/4	0.719	18.3	13/8	1.81	46.0	1.78	45.2
-KKTMM-16-16	1	25	1	0.844	21.5	13/8	1.81	46.0	1.97	50.0
-KKTMM-20-16	1 1/4	32	1	0.844	21.5	111/16	2.06	52.3	2.35	59.6
-KKTMM-20-20	1 1/4	32	1 1/4	1.078	27.5	111/16	2.06	52.3	2.38	60.5
-KKTMM-24-24	1 1/2	38	1 1/2	1.312	33.0	2	2.33	59.2	2.64	67.1
-KKTMM-32-32	2	—	2	1.781	45.0	25/8	3.06	77.7	3.00	76.2

● -KKTTF型内螺纹支管三通接头 Female Branch Tee

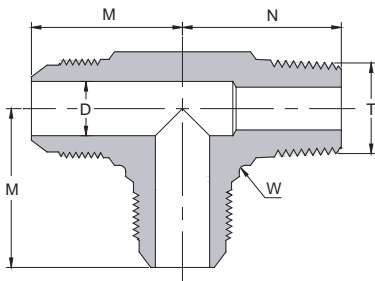


基本订货号 Order information	导管外径Tubing OD		T (NPT)	D		W 英寸 (in)	M		N	
	英寸 (in)	毫米 (mm)		英寸 (in)	毫米 (mm)		英寸 (in)	毫米 (mm)	英寸 (in)	毫米 (mm)
-KKTTF-2-2	1/8	—	1/8	0.062	1.6	5/8	1.00	25.4	0.66	16.8
-KKTTF-3-2	3/16	—	1/8	0.125	3.2	5/8	1.03	26.2	0.66	16.8
-KKTTF-4-2	1/4	6	1/8	0.172	4.4	5/8	1.08	27.4	0.66	16.8
-KKTTF-4-4	1/4	6	1/4	0.172	4.4	13/16	1.22	30.9	0.88	22.4
-KKTTF-5-2	5/16	8	1/8	0.234	6.0	5/8	1.08	27.4	0.66	16.8
-KKTTF-5-4	5/16	8	1/4	0.234	6.0	13/16	1.22	30.9	0.88	22.4
-KKTTF-6-2	3/8	10	1/8	0.297	7.5	5/8	1.06	26.9	0.66	16.8
-KKTTF-6-4	3/8	10	1/4	0.297	7.5	13/16	1.23	31.2	0.88	22.4
-KKTTF-6-6	3/8	10	3/8	0.297	7.5	15/16	1.31	33.2	1.02	25.9
-KKTTF-8-4	1/2	12	1/4	0.391	9.9	13/16	1.25	31.6	0.88	22.4
-KKTTF-8-6	1/2	12	3/8	0.391	9.9	15/16	1.42	36.1	1.02	25.9
-KKTTF-8-8	1/2	12	1/2	0.391	9.9	11/8	1.42	36.1	1.23	31.2
-KKTTF-10-8	5/8	16	1/2	0.484	12.3	11/8	1.64	41.5	1.23	31.2
-KKTTF-12-10	3/4	18	1/2	0.609	15.5	13/8	1.66	42.1	1.23	31.2
-KKTTF-12-12	3/4	18	3/4	0.609	15.5	13/8	1.89	48.0	1.36	34.5
-KKTTF-14-12	7/8	20	3/4	0.719	18.3	13/8	1.86	47.2	1.42	36.1
-KKTTF-16-16	1	25	1	0.844	21.5	15/8	2.17	55.1	1.62	41.1
-KKTTF-20-20	1 1/4	32	1 1/4	1.078	27.5	21/8	2.33	59.2	1.70	43.2
-KKTTF-24-24	1 1/2	38	1 1/2	1.312	33.0	23/8	2.89	73.4	2.08	52.8
-KKTTF-32-32	2	—	2	1.781	45.0	27/8	3.30	83.8	2.39	60.7

XYG-KK系列37° 扩口式接头

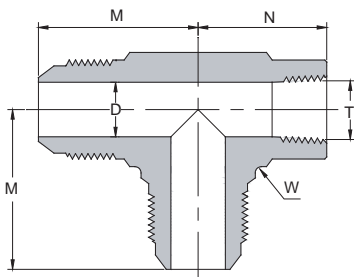
XYG — KK 37° Flared tube fittings

● -KKTMT型外螺纹侧三通接头 Male Side Tee



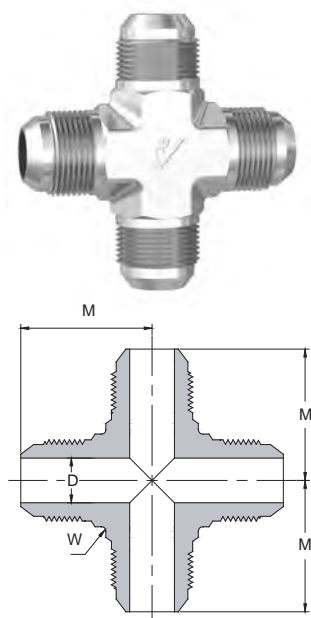
基本订货号 Order information	导管外径Tubing OD		T (NPT)	D		W (in)	M		N	
	英寸 (in)	毫米 (mm)		英寸 (in)	毫米 (mm)		英寸 (in)	毫米 (mm)	英寸 (in)	毫米 (mm)
-KKTMT-2-2	1/8	—	1/8	0.062	1.6	7/16	0.77	19.6	0.72	18.3
-KKTMT-3-2	3/16	—	1/8	0.125	3.2	1/2	0.83	21.1	0.72	18.3
-KKTMT-4-2	1/4	6	1/8	0.172	4.4	1/2	0.89	22.6	0.78	19.8
-KKTMT-4-4	1/4	6	1/4	0.172	4.4	5/8	1.06	26.9	1.09	27.7
-KKTMT-5-2	5/16	8	1/8	0.190	4.8	5/8	0.95	24.1	0.78	19.8
-KKTMT-5-4	5/16	8	1/4	0.234	6.0	5/8	1.06	26.9	1.09	27.7
-KKTMT-6-2	3/8	10	1/8	0.190	4.8	5/8	1.06	26.9	0.90	22.8
-KKTMT-6-4	3/8	10	1/4	0.280	7.1	5/8	1.06	26.9	1.09	27.7
-KKTMT-6-6	3/8	10	3/8	0.297	7.5	13/16	1.14	29.0	1.22	31.0
-KKTMT-6-8	3/8	10	1/2	0.297	7.5	15/16	1.23	31.2	1.47	37.3
-KKTMT-8-4	1/2	12	1/4	0.280	7.1	15/16	1.25	31.8	1.22	31.0
-KKTMT-8-6	1/2	12	3/8	0.380	9.5	15/16	1.25	31.8	1.22	31.0
-KKTMT-8-8	1/2	12	1/2	0.391	9.9	15/16	1.33	33.7	1.47	37.3
-KKTMT-8-12	1/2	12	3/4	0.391	9.9	11/8	1.42	36.0	1.59	40.4
-KKTMT-10-6	5/8	16	3/8	0.380	9.5	15/16	1.45	36.8	1.30	33.0
-KKTMT-10-8	5/8	16	1/2	0.470	11.9	15/16	1.45	36.8	1.47	37.3
-KKTMT-10-12	5/8	16	3/4	0.484	12.3	11/8	1.53	38.9	1.59	40.4
-KKTMT-12-8	3/4	18	1/2	0.470	11.9	11/8	1.66	41.0	1.59	40.4
-KKTMT-12-12	3/4	18	3/4	0.609	15.5	11/8	1.66	41.0	1.59	40.4
-KKTMT-14-12	7/8	20	3/4	0.719	18.3	13/8	1.73	43.9	1.69	42.9
-KKTMT-16-12	1	25	3/4	0.719	18.3	13/8	1.81	46.0	1.78	45.2
-KKTMT-16-16	1	25	1	0.844	21.5	13/8	1.81	46.0	1.97	50.0
-KKTMT-20-16	1 1/4	32	1	0.844	21.5	1 11/16	2.06	52.3	2.35	59.6
-KKTMT-20-20	1 1/4	32	1 1/4	1.078	27.5	1 11/16	2.06	52.3	2.38	60.5
-KKTMT-24-24	1 1/2	38	1 1/2	1.312	33.0	2	2.33	59.2	2.64	67.1
-KKTMT-32-32	2	—	2	1.781	45.0	2 5/8	3.06	77.7	3.00	76.2

● -KKTFT型内螺纹侧三通接头 Female Side Tee



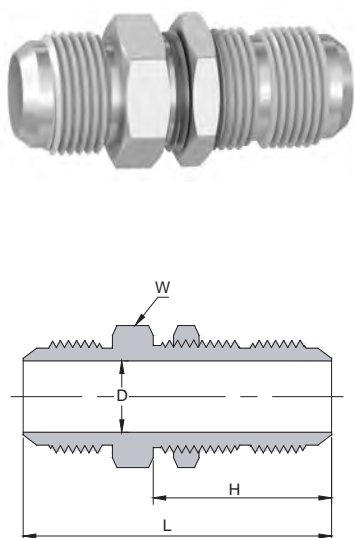
基本订货号 Order information	导管外径Tubing OD		T (NPT)	D		W (in)	M		N	
	英寸 (in)	毫米 (mm)		英寸 (in)	毫米 (mm)		英寸 (in)	毫米 (mm)	英寸 (in)	毫米 (mm)
-KKTFT-2-2	1/8	—	1/8	0.062	1.6	5/8	1.00	25.4	0.66	16.8
-KKTFT-3-2	3/16	—	1/8	0.125	3.2	5/8	1.03	26.2	0.66	16.8
-KKTFT-4-2	1/4	6	1/8	0.172	4.4	5/8	1.08	27.4	0.66	16.8
-KKTFT-4-4	1/4	6	1/4	0.172	4.4	13/16	1.22	30.9	0.88	22.4
-KKTFT-5-2	5/16	8	1/8	0.234	6.0	5/8	1.08	27.4	0.66	16.8
-KKTFT-5-4	5/16	8	1/4	0.234	6.0	13/16	1.22	30.9	0.88	22.4
-KKTFT-6-2	3/8	10	1/8	0.297	7.5	5/8	1.06	26.9	0.66	16.8
-KKTFT-6-4	3/8	10	1/4	0.297	7.5	13/16	1.23	31.2	0.88	22.4
-KKTFT-6-6	3/8	10	3/8	0.297	7.5	15/16	1.31	33.2	1.02	25.9
-KKTFT-8-4	1/2	12	1/4	0.391	9.9	13/16	1.25	31.6	0.88	22.4
-KKTFT-8-6	1/2	12	3/8	0.391	9.9	15/16	1.42	36.1	1.02	25.9
-KKTFT-8-8	1/2	12	1/2	0.391	9.9	11/8	1.42	36.1	1.23	31.2
-KKTFT-10-8	5/8	16	1/2	0.484	12.3	11/8	1.64	41.5	1.23	31.2
-KKTFT-12-10	3/4	18	1/2	0.609	15.5	13/8	1.66	42.1	1.23	31.2
-KKTFT-12-12	3/4	18	3/4	0.609	15.5	13/8	1.89	48.0	1.36	34.5
-KKTFT-14-12	7/8	20	3/4	0.719	18.3	13/8	1.86	47.2	1.42	36.1
-KKTFT-16-16	1	25	1	0.844	21.5	15/8	2.17	55.1	1.62	41.1
-KKTFT-20-20	1 1/4	32	1 1/4	1.078	27.5	2 1/8	2.33	59.2	1.70	43.2
-KKTFT-24-24	1 1/2	38	1 1/2	1.312	33.0	2 3/8	2.89	73.4	2.08	52.8
-KKTFT-32-32	2	—	2	1.781	45.0	2 7/8	3.30	83.8	2.39	60.7

● -KK4型四通中间接头 Cross Union



基本订货号 Order information	导管外径Tubing OD		D		W	L	
	英寸 (in)	毫米 (mm)	英寸 (in)	毫米 (mm)	英寸 (in)	英寸 (in)	毫米 (mm)
-KK4-2	1/8	—	0.062	1.6	7/16	0.77	19.6
-KK4-3	3/16	—	0.125	3.2	1/2	0.83	21.1
-KK4-4	1/4	6	0.172	4.4	1/2	0.89	22.6
-KK4-5	5/16	8	0.234	6.0	5/8	0.95	24.1
-KK4-6	3/8	10	0.297	7.5	5/8	1.06	26.9
-KK4-8	1/2	12	0.391	9.9	15/16	1.25	31.8
-KK4-10	5/8	16	0.484	12.3	15/16	1.45	36.8
-KK4-12	3/4	18	0.609	15.5	1 3/8	1.66	42.2
-KK4-14	7/8	20	0.719	18.3	1 3/8	1.80	45.7
-KK4-16	1	25	0.844	21.5	1 3/8	1.81	46.0
-KK4-20	1 1/4	32	1.078	27.5	1 11/16	2.06	52.3
-KK4-24	1 1/2	38	1.312	33.0	2	2.33	59.2
-KK4-32	2	—	1.781	45.0	2 5/8	3.06	77.7

● -KK61型直通穿板接头 Straight Bulkhead

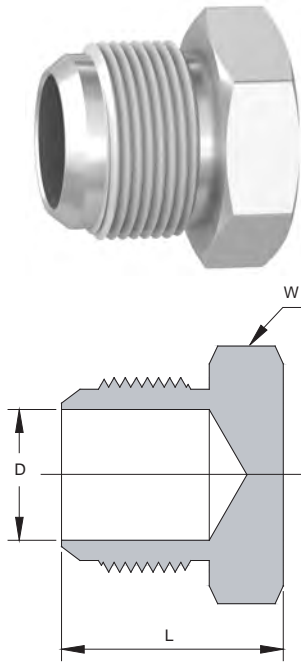


基本订货号 Order information	导管外径Tubing OD		D		W	H		L	
	英寸 (in)	毫米 (mm)	英寸 (in)	毫米 (mm)	英寸 (in)	英寸 (in)	毫米 (mm)	英寸 (in)	毫米 (mm)
-KK61-3	3/16	—	0.125	3.2	5/8	1.11	28.2	1.90	48.3
-KK61-4	1/4	6	0.172	4.4	11/16	1.20	30.5	2.07	52.6
-KK61-5	5/16	8	0.234	6.0	3/4	1.20	30.5	2.07	52.6
-KK61-6	3/8	10	0.297	7.5	13/16	1.28	32.5	2.18	55.4
-KK61-8	1/2	12	0.391	9.9	1	1.44	36.6	2.44	62.0
-KK61-10	5/8	16	0.484	12.3	1 1/8	1.58	40.1	2.74	69.6
-KK61-12	3/4	18	0.609	15.5	1 3/8	1.75	44.4	3.09	78.5
-KK61-14	7/8	20	0.719	18.3	1 1/2	1.75	44.4	3.12	79.2
-KK61-16	1	25	0.844	21.5	1 5/8	1.75	44.4	3.14	79.8
-KK61-20	1 1/4	32	1.078	27.5	1 7/8	1.80	45.7	3.31	84.1
-KK61-24	1 1/2	38	1.312	33.0	2 1/8	1.81	46.0	3.52	89.4
-KK61-32	2	—	1.781	45.0	2 3/4	2.09	53.1	4.20	106.7

XYG-KK系列37° 扩口式接头

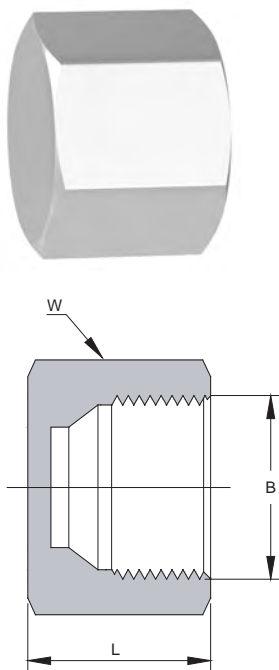
XYG — KK 37° Flared tube fittings

● -KKC型管帽 Cap



基本订货号 Order information	导管外径Tubing OD		D		W	L	
	英寸 (in)	毫米 (mm)	英寸 (in)	毫米 (mm)	英寸 (in)	英寸 (in)	毫米 (mm)
-KKC-2	1/8	—	0.062	1.6	7/16	0.70	17.8
-KKC-3	3/16	—	0.125	3.2	7/16	0.73	18.5
-KKC-4	1/4	6	0.172	4.4	1/2	0.80	20.3
-KKC-5	5/16	8	0.234	6.0	9/16	0.80	20.3
-KKC-6	3/8	10	0.297	7.5	5/8	0.84	21.3
-KKC-8	1/2	12	0.391	9.9	13/16	0.94	23.9
-KKC-10	5/8	16	0.484	12.3	15/16	1.10	27.9
-KKC-12	3/4	18	0.609	15.5	1 1/8	1.28	32.5
-KKC-14	7/8	20	0.719	18.3	1 1/4	1.31	33.3
-KKC-16	1	25	0.844	21.5	1 3/8	1.33	33.8
-KKC-20	1 1/4	32	1.078	27.5	1 11/16	1.45	36.8
-KKC-24	1 1/2	38	1.312	33.0	2	1.65	41.9
-KKC-32	2	—	1.781	45.0	2 5/8	2.05	52.1

● -KKP型堵头 Plug



基本订货号 Order information	导管外径Tubing OD		B	W	L	
	英寸 (in)	毫米 (mm)	(UNF)	英寸 (in)	英寸 (in)	毫米 (mm)
-KKP-2	1/8	—	5/16-24	3/8	0.550	12.7
-KKP-3	3/16	—	3/8-24	7/16	0.562	14.3
-KKP-4	1/4	6	7/16-20	9/16	0.594	15.1
-KKP-5	5/16	8	1/2-20	5/8	0.609	15.5
-KKP-6	3/8	10	9/16-18	11/16	0.625	15.9
-KKP-8	1/2	12	3/4-16	7/8	0.750	19.0
-KKP-10	5/8	16	7/8-14	1	0.844	21.4
-KKP-12	3/4	18	1 1/16-12	1 1/4	0.906	23.0
-KKP-14	7/8	20	1 3/16-12	1 3/8	0.969	24.6
-KKP-16	1	25	1 5/16-12	1 1/2	1.016	25.8
-KKP-20	1 1/4	32	1 5/8-12	2	1.062	27.0
-KKP-24	1 1/2	38	1 7/8-12	2 1/4	1.188	30.2
-KKP-32	2	—	2 1/2-12	2 7/8	1.438	36.5

SINYA

港商 扬中新亚自控工程有限公司
独资 YANGZHONG SINYA AUTO-CONTROL ENGINEERING CO., LTD.

地址：江苏省扬中经济开发区兴隆港北路

Add: Xinglong Port, Yangzhong, Zhenjiang, Jiangsu, China

电话(Tel): 0511-88783806

传真(Fax): 0511-88451691

网址(Http): www.sklok.com

邮箱(E-mail): sales@sklok.com info@sklok.com